

58. Dimensions of water closet windows? _____
 Dimensions of windows for living rooms? _____
59. Of what materials will hall partitions be constructed? _____

60. Of what materials will hall floors be constructed? _____

61. How will hall ceilings and soffits of stairs be plastered? _____
62. Of what material will stairways be constructed? _____
 Give sizes of stair well holes? _____
63. If any other building on lot, give size; front _____; rear _____; deep _____
 stories high _____; how occupied _____; on front or rear
 of lot _____; material _____.
 How much space between it and proposed building? _____
64. How will floors and sides of water closets to the height of 16 inches be made waterproof? _____

65. Number and location of water closets: Cellar _____; 1st floor _____; 2d floor _____;
 3d floor _____; 4th floor _____; 5th floor _____; 6th floor _____.
66. This building will safely sustain per superficial foot upon the 1st floor _____ lbs.; upon 2d floor
 _____ lbs.; upon 3d floor _____ lbs.; upon 4th floor _____ lbs.; upon 5th floor _____
 lbs.; upon 6th floor _____ lbs.; upon 7th floor _____ lbs.; upon 8th floor _____ lbs.
67. Is architect to supervise the alteration of the building or buildings mentioned herein? yes
 Name Herman Goldberg
 Address 2968 Briggs Ave N.Y. City
68. If not the architect, who is to superintend the alteration of the building or buildings described herein?
 Name _____
 Address _____

Owner, People's Hospital Address, 203 Second Avenue
 Architect, Herman Goldberg " 2968 Briggs Ave. N.Y.C.
 Mason, _____ " _____
 Carpenter Names to be given hereafter " _____

Lot 36

Office for Metropolitan History

NEW SEARCH [Printable Format](#)

MANHATTAN NB DATABASE SEARCH RESULTS, SORTED BY YEAR

Citation format: Office for Metropolitan History, "Manhattan NB Database 1900-1986," (date of access), <http://www.MetroHistory.com>

SEARCH PARAMETERS: YEAR: 1912,

1 RECORDS FOUND, DISPLAYING (1 TO 1)

YEAR	DOB NB#	COST	BUILDING ADDRESS	DESCRIPTION
1912	451	\$500.00	2D [Second] AV, 203	1-sty laboratory, 12x 12
OWNER / OWNER ADDRESS (o) Peoples Hospital / (o) 203 2d [Second] av COMMENTS				
ARCHITECT / ARCHITECT ADDRESS (a) H. G. Knapp / (a) 123 Liberty st				

1 RECORDS FOUND, DISPLAYING (1 TO 1)

NEW SEARCH

[Home](#) | [Document Recovery](#) | [Reports](#) | [Writing](#) | [Building Permit Search](#) | [Contact](#)

→ Extension for rear yard
- 12x12 laboratory

THE BUREAU OF BUILDINGS OF THE CITY OF NEW YORK

FOR THE BOROUGH OF MANHATTAN

PLAN No. 158

of 1911

BUREAU OF BUILDINGS
FOR THE CITY OF NEW YORK
NEW BUILDINGS
ALTERATIONS
JAN 11 1911
BOROUGH OF MANHATTAN

STATE AND CITY OF NEW YORK,
COUNTY OF NEW YORK.

ss.: Herman Goldberg

being duly sworn, deposes and says: That he resides at Number 2968 Briggs Ave
in the Borough of Bronx
in the City of New York, in the County of New York
in the State of NY, that he is the architect for the
The Peoples Hospital, the

owner in fee of all that certain lot, piece or parcel of land, shown on the diagram annexed hereto and made
a part hereof, situate, lying and being in the Borough of Manhattan
in The City of New York aforesaid, and known and designated as Number 203 Second
Ave, and hereinafter more particularly described;

that the work proposed to be done upon the said premises, in accordance with the accompanying detailed
statement in writing of the specifications and plans of such proposed work, is duly authorized to be
performed by the said owner

and that Herman Goldberg, the architect
duly authorized by the said owners
to make application for the approval of such detailed statement of specifications and plans
in its behalf.

Deponent further says that the full names and residences, street and number, of the owner or
owners of the said land, and also of every person interested in said building or proposed building, structure
or proposed structure, premises, wall, platform, staging or flooring, either as owner, lessee, or in any
representative capacity, are as follows:

- Peoples Hospital No. 203 Second Ave
as owner
- Mr. M. Greenbaum No. 342 E 50th St
as President
- Max Scott No. 580 Broadway
as Treasurer
- Herman Goldberg No. 2968 Briggs Ave
as Architect
- No. _____
as _____

The said land and premises above referred to are situate at, bounded and described as follows, viz.:

BEGINNING at a point on the west side of Second
Ave, distant 55 feet
south from the corner formed by the intersection of
Second Ave and 13th St
running thence south 26 feet;
thence west 100 feet feet;
thence north 26 feet;
thence east 100 feet
to the point or place of beginning.

Sworn to before me, this 23rd
day of January 1912 } Herman Goldberg

Francis Koch
COMMISSIONER OF DEEDS,
Notary Public, CITY OF NEW YORK, County.

BLOCK No. 468
LOT No. 26

BUREAU OF BUILDINGS
OF THE CITY OF NEW YORK

Office of the Borough President of the Borough of Manhattan,
In The City of New York.

Received
FOR THE BOROUGH
OF MANHATTAN.

B 468
L 36

4

THE BUREAU OF BUILDINGS FOR THE BOROUGH OF MANHATTAN,
Office, No. 220 FOURTH AVENUE,
S. W. Corner 18th Street.

Block # 468
Foot. 57.

Plan No. 451

APPLICATION FOR ERECTION OF BRICK BUILDINGS.

Application is hereby made to the Superintendent of Buildings of The City of New York, for the Borough of Manhattan, for the approval of the detailed statement of the specifications and plans herewith submitted, for the erection of the building herein described. All provisions of the law shall be complied with in the erection of said building whether specified herein or not.

(Sign here) H. G. Purpffe

THE CITY OF NEW YORK,

BOROUGH OF MANHATTAN, July 16 1902

1. State how many buildings to be erected one
2. What is the exact location thereof? (State on what street or avenue; the side thereof, the number of feet from the nearest street or avenue, and the name thereof) 203rd Second Avenue, west side, 50 ft. south of De R. St.
3. Will the building be erected on the front or rear of lot? rear
4. How to be occupied? habitation If for dwelling, state the number of families in each house.
5. Size of lot? 25 feet front; 25 feet rear; 100 feet deep.
Give diagram of same.
6. Size of building? 12 feet front; 12 feet rear; 14 feet deep.
Size of extension? _____ feet front; _____ feet rear; _____ feet deep.
Number of stories in height: main building? one Extension? _____
Height from curb level to highest point: main building? 8 feet. Extension? _____ feet.
7. What is the character of the ground: rock, clay, sand, etc.? Sand & loam
8. Will the foundation be laid on earth, rock, timber or piles? Earth
9. Will there be a cellar? No
10. What will be the base, stone or concrete? concrete If base stones, give size and thickness, and how laid. _____ If concrete, give thickness 12"
11. What will be the depth of foundation walls below curb level or surface of ground? 4 ft.
12. Of what will foundation walls be built? (brick)
13. Give thickness of foundation walls: front, _____ inches; sides, _____ inches; rear, _____ inches; party, _____ inches.
14. Will interior supports be brick partition walls or piers, iron columns or wooden posts? _____
Give size of same _____
15. If piers, give thickness of cap stones or plates _____ bond stones or plates _____

Building to be constructed conformably with Bulletin # 22 - 1912

16. Give base course, width and thickness 12"

17. Will any part of front, side or rear wall, be supported on piers in cellar?

Give size: front size of base course
rear " " "
side " " "

Size of cap stones size of bond stones

18. Of what materials will the upper walls be constructed? Steel

What will be thickness of upper walls, exclusive of ashlar, if any? 1 1/2"

	Basement: front	inches;	rear	inches;	side	inches;	party	inches.
1st story:	"	"	"	"	"	"	"	"
2d story:	"	"	"	"	"	"	"	"
3d story:	"	"	"	"	"	"	"	"
4th story:	"	"	"	"	"	"	"	"
5th story:	"	"	"	"	"	"	"	"
6th story:	"	"	"	"	"	"	"	"
7th story:	"	"	"	"	"	"	"	"

19. What will be the materials of the front? Steel If of stone, what kind? If ashlar, give thickness

20. Will flues be lined with pipe or have 8 inches of brick around the same?

21. Will any wall be supported on iron or steel girders?

	Front, material	size	weight or thickness
Side,	"	"	" " "
Rear,	"	"	" " "
Interior,	"	"	" " "

Will any wall be supported on iron or steel columns?

	Front, material	size	weight or thickness
Side,	"	"	" " "
Rear,	"	"	" " "
Interior,	"	"	" " "

22. Give material of girders of columns

	Under 1st tier, size of girders	size of columns
" 2d tier,	" "	" "
" 3d tier,	" "	" "
" 4th tier,	" "	" "
" 5th tier,	" "	" "
" Roof tier,	" "	" "

23. Give material, size and distance on centres of floor beams.

	1st tier, material	size	distance on centres
2d tier,	"	"	" "
3d tier,	"	"	" "
4th tier,	"	"	" "
5th tier,	"	"	" "
6th tier,	"	"	" "
7th tier,	"	"	" "
8th tier,	"	"	" "
Roof tier,	"	"	" "

Give thickness of headers of trimmers

24. Specify construction of floor filling None floor over curbed fill

25. Is the building to be fire proof? no
26. Of what material w partitions be built? Cross — fore and aft —
27. Give material of skylights —; size —
28. What will be the material of roofing? Steel (cylindrical) Will roof be flat, peak or mansard? Peak
29. What will be the material of dumb waiter shafts? —
30. What will be the material of elevator shafts? —
31. What will be the material of the cornices? —
32. What will be the material of bay windows? —
33. What kind of fire escape will be provided? —
34. Will cellar be plastered? — How? —
35. Will access to roof be by scuttle or bulkhead? — If by bulkhead, how constructed? —
36. With what material will walls be coped? —
37. How will building be heated? Gas stove
38. Is there any other building erected on lot or permit granted for one? Yes
 Size 25' x 55'; height — feet. How occupied? Hospital
 Give distance between same and proposed building 25' feet.
39. Are any buildings to be taken down? no; how many? —

If the Building is to be occupied as a Flat, Apartment, Tenement or Lodging House, give the following particulars :

40. Is any part of building to be used as a store or for any other business purpose? If so state for what?
—

	Cellar.	Base-ment.	1st Floor	2d Floor	3d Floor	4th Floor	5th Floor	6th Floor	7th Floor
41. How many families will occupy each? - - -									
42. Height of ceilings? - - -									

43. How basement to be occupied? —
 How made water-tight? —
44. How will cellar stairs be enclosed? —
45. How cellar to be occupied? —
 How made water-tight? —
46. Will shafts be open or covered with louvre skylights full size of shafts? —
 Size of each shaft? —
47. Dimensions of water-closet windows? —
 Dimensions of windows for living rooms? —
48. Of what materials will hall partitions be constructed? —
49. Of what materials will hall floors be constructed? —

50. How will the ceilings and soffits of stairs be plastered?
51. Of what material will stairways be constructed?
- Give sizes of stair well holes
52. If any other building on lot, give size: front; rear; deep; stories high; how occupied; on front or rear of lot; material
- How much space between it and proposed building?
53. How will floors and sides of water closets to the height of 16 inches be made waterproof?
54. Number and location of water closets: Cellar; 1st floor; 2d floor; 3d floor; 4th floor; 5th floor; 6th floor; 7th floor
55. This building will safely sustain per superficial foot upon the 1st floor lbs.; upon 2d floor lbs.; upon 3d floor lbs.; upon 4th floor lbs.; upon 5th floor lbs.; upon 6th floor lbs.; upon 7th floor lbs.; upon 8th floor lbs.
56. What is the estimated cost of each building, exclusive of lot? \$500⁰⁰
57. What is the estimated cost of all the buildings, exclusive of lots? \$

Owner, Peoples Hospital
Moses Graubman, Pres. Address, 203 Second Ave.
Meyer Graubman, Secy.
 Architect, H. G. Knapp " 123 Liberty St.
 Superintendent, " " "
 Mason, " "
 Carpenter, " "

If a Wall, or Part of a Wall already built is to be used, fill up the following:

THE CITY OF NEW YORK,

BOROUGH OF MANHATTAN, 190

The undersigned gives notice that intend to use the wall of building

 as party wall in the erection of the building hereinbefore described, and respectfully requests that the
 same be examined and a permit granted therefor. The foundation wall built of
 inches thick, feet below curb; the upper wall built of
 inches thick, feet deep, feet in height.

(Sign here)

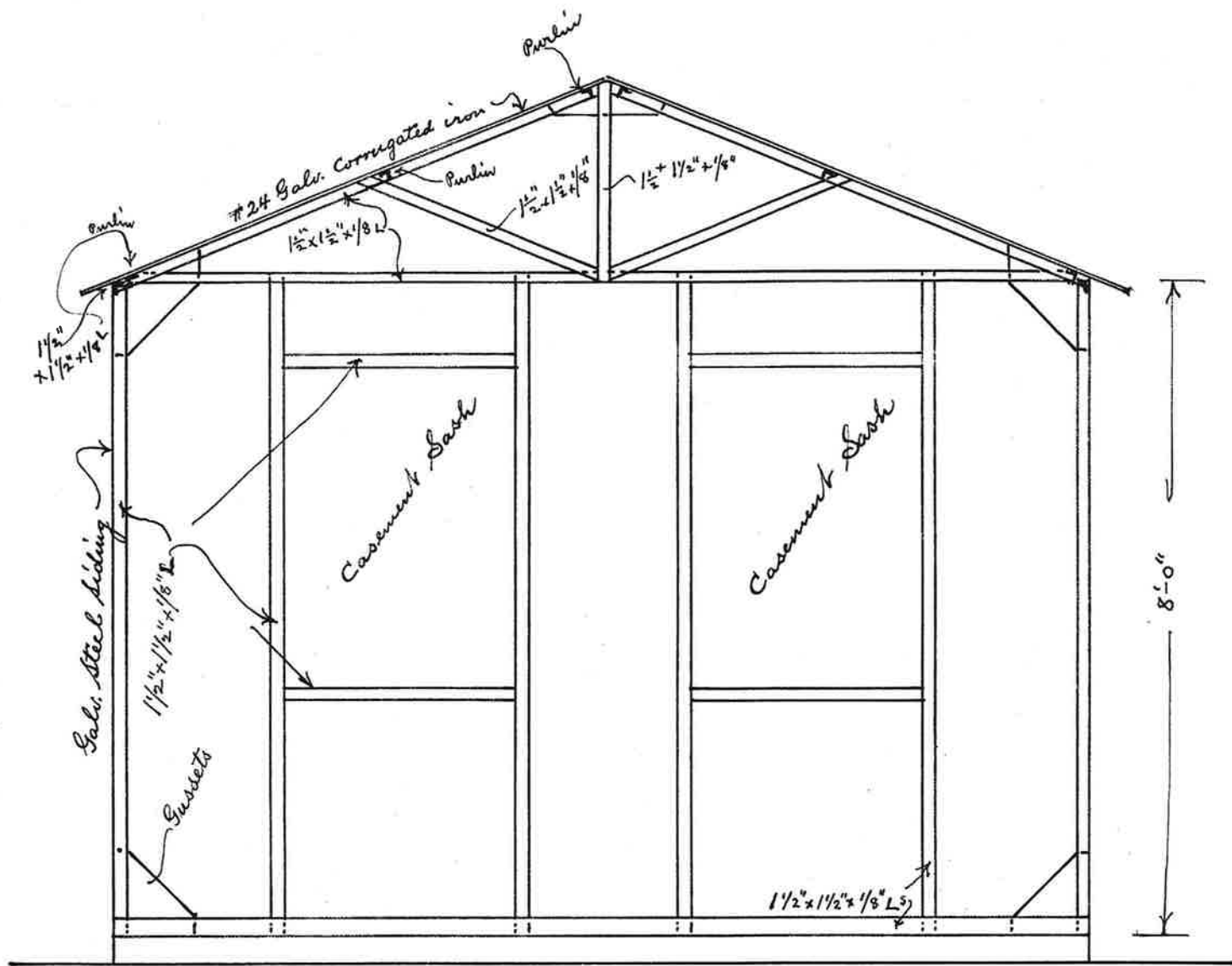

1/2" SCALE SECTION OF FRAME

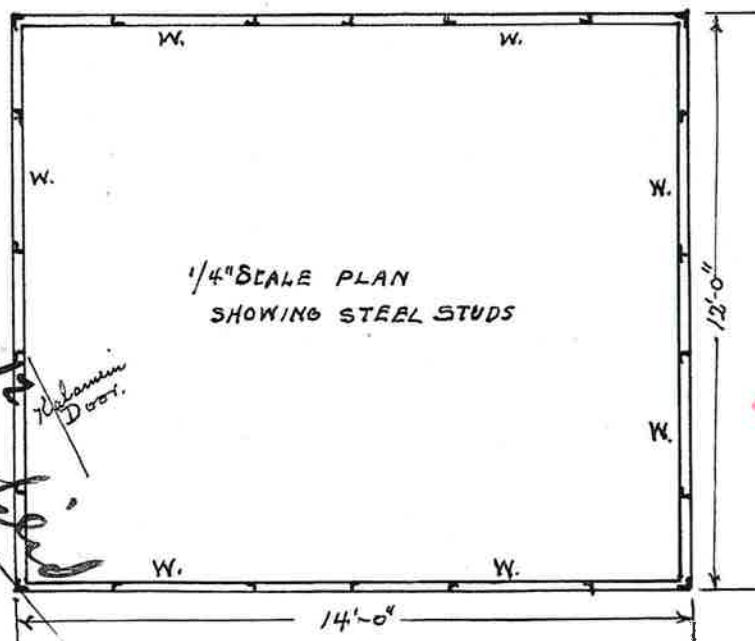

*MB 4511
1 add show plan*

*H. G. Knapp
architect
111 Broadway
New York*

AC Bureau of Buildings, Manhattan

PLAN No. 451 of 19 2 NEW BUILDINGS ALTERATIONS

STATE AND CITY OF NEW YORK, } ss.:
COUNTY OF NEW YORK.

H. G. Knapp

being duly sworn, deposes and says: That he resides at Number 123 Liberty Street in the Borough of Manhattan in the City of New York, in the County of New York in the State of N. Y., that he is The People's Hospital.

Mr. Moses Greenbaum, President, is

owner in fee of all that certain lot, piece or parcel of land, shown on the diagram annexed hereto and made a part hereof, situate, lying and being in the Borough of Manhattan in The City of New York, aforesaid, and known and designated as Number 203 Second Avenue

and hereinafter more particularly described; that the work proposed to be done upon the said premises, in accordance with the accompanying detailed statement in writing of the specifications and plans of such proposed work, is duly authorized to be performed by said People's Hospital (Moses Greenbaum, President)

and that he is duly authorized by said People's Hospital to make application for the approval of such detailed statement of specifications and plans in said Hospital's behalf.

Deponent further says that the full names and residences, street and number, of the owner or owners of the said land, and also of every person interested in said building or proposed building, structure or proposed structure, premises, wall, platform, staging or flooring, either as owner, lessee, or in any representative capacity, are as follows:

- PEOPLE'S HOSPITAL No. 203 Second Avenue as Owner
H. G. Knapp No. 123 Liberty Street as Architect
Meyer Greenberg No. 20 Second Avenue as President
Moses Greenbaum No. 203 Second Avenue as President

The said land and premises above referred to are situate at, bounded and described as follows, viz.:

BEGINNING at a point on the West side of Second Avenue

....., distant 50 feet

South 7/16 from the corner formed by the intersection of
East Thirteenth Street and Second Avenue

..... running thence West 100 feet;

thence South 25 feet;

thence East 100 feet;

thence North 25 feet

to the point or place of beginning. Lot # 36
Brooklyn

Sworn to before me, this 12th
day of JULY 1913

J. J. J.

James B. Ross
Notary Public, New York County.

9-18-13

Form No. 1-1003.

BUREAU
OF THE
BOROUGH

Detailed Statement
ERECTION

No. 301

Richard
A. J. S.

Owner J. J. J.

Architect

Builder

Received by

Returned by

R.

Referred to

Return

7-7

Office of the Borough President of the Borough of Manhattan,
In The City of New York.

THE BUREAU OF BUILDINGS FOR THE BOROUGH OF MANHATTAN,
Office, No. 220 FOURTH AVENUE,
S. W. Corner 18th Street.

The City of New York, Sept. 3, 1912.

Amendment to Application No. 451

{ ~~Alt. B,~~
New B, 1912

Location Second Avenue, W.S., 50 ft. s. of e. 18th Street.

The above application is hereby amended as follows:

Additional drawing is filed herewith, showing all structural parts and enclosing material.

Construction is identical with that of the building shown in the photograph attached to the drawing--representing a 12' x 20' building in the Borough of Brooklyn--approved by the Bureau of Buildings in said Borough.

Roof covering is of galvanized corrugated iron, #24 gauge. Sides of building are covered with #24 galv. iron "weather board" sheets. All of the covering is riveted and bolted together and to the steel angle frame.

Frame of building is with 1 1/2" x 1 1/2" steel angles, 1/8" thick, thoroughly braced with 1/2" steel gusset plates.

Respectfully submitted,

H. G. Knapp

to
Construction

Isaac M. Sulline

OK. H. D. Sew.

[Faint, mostly illegible text from a stamp or form, possibly containing a date and official name.]

[Handwritten initials or signature.]