

ORIGINAL

Applicant must indicate the Building Line or Lines clearly and distinctly on the Drawings.

Department of Buildings of The City of New York.

THOMAS J. BRADY,
 President of the Board of Buildings and
 Commissioner of Buildings for the Bor-
 oughs of Manhattan and The Bronx.
 Office, No. 220 Fourth Avenue, S. W. cor. 18th Street,
 Borough of Manhattan.

JOHN GUILDFOYLE,
 Commissioner of Buildings for
 the Borough of Brooklyn.
 Office, Borough Hall, Borough of Brooklyn.

DANIEL CAMPBELL,
 Commissioner of Buildings for the Bor-
 oughs of Queens and Richmond.
 Office, Richmond Building, New Brighton, Staten Island,
 Borough of Richmond.
 Branch Office, Town Hall, Jamaica, Long Island,
 Borough of Queens.

Plan No. 77

APPLICATION FOR ERECTION OF BRICK BUILDINGS.

Application is hereby made to the Commissioner of Buildings of The City of New York, for the Borough of Manhattan for the approval of the detailed statement of the specifications and plans herewith submitted, for the erection of the building herein described. All provisions of the Building Code shall be complied with in the erection of said building whether specified herein or not.

(Sign here) Sass & Smallpiece

THE CITY OF NEW YORK,

'BOROUGH OF Manhattan Feb. 20 1902

1. State how many buildings to be erected Four
2. What is the exact location thereof? (State on what street or avenue; the side thereof, the number of feet from the nearest street or avenue, and the name thereof) South side of E. 14th St. 139 ft. W. of 2nd Ave. # 226 to 238 E. 14th St.
3. Will the building be erected on the front or rear of lot? Front
4. How to be occupied? Stores & Dwellings If for dwelling, state the number of families in each house 22
5. Size of lot? 46'-4 1/2" feet front; 46'-4 1/2" feet rear; 103'-3" feet deep. Give diagram of same.
6. Size of building? 46'-4 1/2" feet front; 33'-4 1/2" feet rear; 90'-3" feet deep. Size of extension? _____ feet front; _____ feet rear; _____ feet deep. Number of stories in height: main building? 6 Extension? _____ Height from curb level to highest point: main building? 67 feet. Extension? _____ feet.
7. What is the character of the ground: rock, clay, sand, etc.? Natural ground
8. Will the foundation be laid on earth, rock, timber or piles? Earth
9. Will there be a cellar? yes
10. What will be the base, stone or concrete? Concrete If base stones, give size and thickness, and how laid _____ If concrete, give thickness 12" thick
11. What will be the depth of foundation walls below curb level or surface of ground? 10 ft.
12. Of what will foundation walls be built? Brick
13. Give thickness of foundation walls: front, _____ inches; sides, 20 inches; rear, 20 inches; party, 20 inches.
14. Will interior supports be brick partition walls or piers, iron columns or wooden posts? Brick walls Give size of same 12" x 16"
15. If piers, give thickness of cap stones or plates _____ bond stones or plates _____

469
 21, 23, 25, 27
 22, 24, 26, 28

16. Give base course, width and thickness _____
 17. Will any part of front, side or rear wall, be supported on piers in cellar?
 Give size: front $1'8'' \times 2'-0''$, $2'-0'' \times 2'-0''$ & $2'-0'' \times 2'-4''$ size of base course $3'-8'' \times 4'-0''$, $4'-0'' \times 4'-0''$ & $4'-0'' \times 4'-4''$
 rear _____ " " "
 side _____ " " "

Size of cap stones $20'' \times 24'' \times 12''$, $16'' \times 20'' \times 12''$, $20'' \times 20'' \times 12''$ & $24'' \times 24'' \times 12''$ size of bond stones $4''$ thick & full size of piers

18. Of what materials will the upper walls be constructed? Brick
 What will be thickness of upper walls, exclusive of ashlar, if any?

	Basement:	front	inches;	rear	inches;	side	inches;	party	inches.
1st story:	"	"	"	16	"	"	16	"	16
2d story:	"	16	"	"	16	"	"	16	"
3d story:	"	12	"	"	12	"	"	12	"
4th story:	"	12	"	"	12	"	"	12	"
5th story:	"	12	"	"	12	"	"	12	"
6th story:	"	12	"	"	12	"	"	12	"
7th story:	"	"	"	"	"	"	"	"	"

19. What will be the materials of the front? Brick If of stone, what kind? _____ If ashlar, give thickness _____

20. Will flues be lined with pipe or have 8 inches of brick around the same? Burnt clay pipes

21. Will any exterior or interior wall be supported on iron or steel girders?
 Front, size 3-15" Steel I^s ✓; weight or thickness 60 lbs per ft.
 Side, " " " " "
 Rear, " " " " "
 Interior, 3-6" Steel I^s ✓ " " 12 lbs per ft. } under front
 Front, 2-6" " " " ✓ " " 12 " " " } partition wall
 Side, 4 girders of 2-10" I^s ✓ " " 25 " " " } supporting girder under
 Rear, 5 " " 2-9" I^s ✓ " " 21 " " " } front partition wall
 Interior, 3-10" steel I^s ✓ " " 25 " " " } supporting chimneys above
3-8" " " " ✓ " " 9 3/4 " " " } 1st story

22. Give size of columns, posts or girders to support floors.
 Cellar, material _____; size _____; distance on centres _____
 1st story, " Cast Iron " 8" x 12" x 1/2", 12" x 16" x 1/2" & 16" x 16" x 1/2" "
 2d story, " _____ " " "
 3d story, " _____ " " "
 4th story, " _____ " " "
 5th story, " _____ " " "

23. Give material, size and distance on centres of floor beams.
 1st tier, material Steel; size 6-12 lbs & 7-15 lbs ✓ distance on centres 3'-9" - 4'-0" ✓
 2d tier, " Spruce " 3" x 8" ✓ " " 12' x 16' } 3x8" beams to be
 3d tier, " Spruce " 3" x 8" & 4" x 8" ✓ " " 15' x 16' } set 12" on centres
 4th tier, " Spruce " 3" x 8" & 4" x 8" ✓ " " 12' x 16' } when span exceeds
 5th tier, " Spruce " 3" x 8" & 4" x 8" ✓ " " 18'-6" and 4" x 8"
 6th tier, " Spruce " 3" x 8" & 4" x 8" ✓ " " 12' x 16' } beams to be used
 7th tier, " _____ " _____ " _____ " _____ when span exceeds
 8th tier, " _____ " _____ " _____ " _____ 21'-6"
 Roof tier, " Spruce " 3" x 8" ✓ " " 16' x 20'

24. Specify construction of floor filling Bonded Brick Arches in public halls & 1st story only

25. Is the building to be fire proof? Public Halls only
26. Of what material will partitions be built? Public hall to be enclosed with brick walls, other partitions to be of 2x4 hemlock & spruce joists 16" centres.
27. What will be the material of roofing? Asph Will roof be flat, peak or mansard? flat
28. What will be the material of dumb waiter shafts? Angle iron filled with brick & F.P. blocks
29. What will be the material of elevator shafts? _____
30. What will be the material of bay windows? Brick
31. What kind of fire escape will be provided? Iron balconies with regular steps
32. Give size of vent shafts to water closet apartments Open courts; and of what material constructed Brick
33. Will access to roof be by scuttle or bulkhead? Bulkhead If by bulkhead, how constructed? Brick
34. With what material will walls be coped? Tile or Blue stone
35. How will building be heated? Steam
36. Is there any building already erected on lot? no If so, and the same is to remain, state how occupied? _____ Size _____
Number of feet between buildings? _____
37. Are any buildings to be taken down? none; how many? _____
38. What is the estimated cost of each building, exclusive of lot? \$ 45,000 ⁵⁰/₁₀₀
What is the estimated cost of all the buildings, exclusive of lots? \$ 180,000 ⁵⁰/₁₀₀

If the Building is to be occupied as a Flat, Apartment, Tenement or Lodging House, give the following particulars :

39. State what per centum of lot is to be occupied? _____
40. How many feet open space will remain between building and rear line of lot? _____
41. Is any part of building to be used as a store or for any other business purpose, if so, state for what? _____

	Cellar	Base-ment	1st Floor	2d Floor	3d Floor	4th Floor	5th Floor	6th Floor	7th Floor
42. How many families will occupy each? - -									
43. Height of ceilings? - - - -									
44. Number of living rooms opening on shafts and courts?									
45. Number of living rooms opening on street and yard?									

46. How basement to be occupied? _____ Height of basement ceiling above sidewalk? _____
How lighted and ventilated? _____
How made water-tight? _____
47. Will cellar or basement ceiling be plastered? _____ How? _____
48. How will cellar stairs be enclosed? _____
49. How cellar to be occupied? _____ Height of cellar ceiling above sidewalk? _____
How lighted and ventilated? _____
How made water-tight? _____
50. Give number of light and vent shafts _____
State materials to be used in their construction _____

51. Will shafts be open or covered with louvre skylights full size of shafts? _____

 Size of each shaft? _____ *allow* _____

52. Dimensions of windows for living rooms? _____
53. What doors will have fan lights? _____
 Dimensions of same? _____
54. Of what materials will hall partitions be constructed? _____

55. Of what materials will hall floors be constructed? _____

56. How will hall ceilings and soffits of stairs be plastered? _____
57. How will halls be lighted and ventilated? _____
58. Of what material will stairways be constructed? _____

59. If any other building on lot, give size: front _____; rear _____; deep _____;
 stories high _____; how occupied _____; on front or rear
 of lot _____; material _____
 How much space between it and proposed building? _____
60. How will floors and sides of water closets to the height of 16 inches be made waterproof? _____

61. Number and location of water closets: Cellar _____; 1st floor _____; 2d floor _____;
 3d floor _____; 4th floor _____; 5th floor _____; 6th floor _____;
 7th floor _____
62. Total area of shafts over 25 square feet? _____ Of courts? _____

Owner, *Merberg Bros.* Address, *232 E 10th St*
 Architect, *Sass & Smallheiser* " *23 Park Row*
 Superintendent, *Owens* " _____
 Mason, _____ " _____
 Carpenter, _____ " _____

If a Wall, or Part of a Wall already built is to be used, fill up the following:

THE CITY OF NEW YORK,

BOROUGH OF _____ 190

The undersigned gives notice that _____ intend to use the _____ wall of building

 as party wall in the erection of the building hereinbefore described, and respectfully requests that the
 same be examined and a permit granted therefor. The foundation wall _____ built of _____
 _____ inches thick, _____ feet below curb; the upper wall _____ built of _____,
 _____ inches thick, _____ feet deep, _____ feet in height.

(Sign here) _____

ORIGINAL

Tenement House Department
of the City of New York.

Form 1, 1902.

TENEMENT HOUSE DEPARTMENT

OF

THE CITY OF NEW YORK.

Manhattan Office :
No. 61 IRVING PLACE,
S. W. Cor. 18th Street.

Brooklyn Office :
TEMPLE BAR BUILDING,
No. 44 Court Street,
Cor. Joralemon Street.

Plan No. 10 190 2 Filed February 10 190 2

APPLICATION FOR ERECTION OF NEW TENEMENT HOUSE.

APPLICATION is hereby made to the Tenement House Commissioner of The City of New York for the approval of the detailed statement of the specifications and plans herewith submitted, for the erection of the Tenement House herein described. The applicant agrees to comply with all provisions of law and ordinances in the erection of said building whether specified herein or not.

(Sign here)

Wass + Smallhiser, Architects

Address

23 Park Row

Applications must be filed in TRIPLICATE and drawings in DUPLICATE.

NOTE.—In making application for the approval of plans for a new tenement house the following drawings must be furnished: Plans of all floors, including cellar and basement, an elevation showing heights of stories, and, if necessary, transverse and longitudinal sections. All plans must be drawn to a uniform scale, not less than one-quarter inch to the foot, and be on linen tracing cloth or be cloth prints. After approval by the Tenement House Department one set of plans and a certificate of approval will be at once forwarded to the Bureau of Buildings by the Department. The dimensions and boundaries of each lot must be clearly marked on plans, as must the measurements of all courts, yards, vent-shafts, rooms and halls, as well as the use to which each room is to be put. With each application must be filed a written statement signed by the owner of the proposed building, authorizing the person signing this application to make such application. There must also be filed with this application a diagram or survey of the property, on linen tracing cloth, showing the width and depth of the lot and its location and distance from adjacent streets.

All amendments to plans and applications must be made on a separate blank provided for that purpose, and where changes affecting sizes of lots, buildings, courts, rooms, or halls are made, separate drawings showing such changes must be filed.

NOTE—Where it is proposed to convert or alter to the purposes of a tenement house a building not used for such purpose, the form of application used for the erection of a new tenement-house must be filed in the Department and must be completely filled out.

THE CITY OF NEW YORK,

BOROUGH OF Manhattan Date Feb. 6 190 2.

1. State how many tenement houses to be erected. Four
2. What is the exact location thereof? (State on what street or avenue, the side thereof, the number of feet from the nearest street or avenue, and the name

5. Person superintending construction of building. *Owner*
 (Whether Owner or Architect)
 Address *232 E. 10th Str.*
6. Estimated cost of each building, exclusive of the lot, \$ *45000⁰⁰*
7. Estimated cost of all buildings, exclusive of the lot, \$ *180000⁰⁰*
8. Will the building be erected on the front or rear of lot? *front*
9. How to be occupied? *stone & terrace* .. State the number of families in each house *2-2*
10. Size of each lot? *46* feet *4 1/2* inches front; *46* feet *4 1/2* inches rear;
103 feet *3* inches deep.
11. Size of each building? *46* feet *4 1/2* inches front; *33* feet *4 1/2* inches rear; *90* feet *3* inches deep.
 Size of each extension? feet inches front; feet inches rear;
 feet inches deep.
12. Material of building *brick*
13. Number of stories above cellar or basement of main building? *6*
14. Number of stories above cellar or basement of extension?
15. Will there be a basement? *no* Will there be a cellar? *yes*
16. Height of building through centre of facade from curb-level to highest point of roof beams? (Sec. 52) *67* feet. Height of extension feet
 State height and area of all roof bulkheads. *8 ft. high; 120 sq. ft.*
17. State width of widest street on which building is to be located? (Sec. 52) (measured from building line to building line) *100 ft.*
18. Is building to be on a corner lot, or on an interior lot? (Sec. 5) *interior*
19. What per centum of lot will be occupied (when measurements are taken at the ground level)? (Sec. 51) *68.5%*
20. What will be the depth of the yard from extreme rear of building to rear lot line? (Secs. 53, 54, 55, 56) *13'-0"*
21. Give sizes of unoccupied space in schedule below (Secs. 51-64, incl.):

NOTE.—Under the provisions of sections 51 to 64 of the Tenement House Act (chapter 334 of the Laws of 1901), the size of all open spaces is regulated by the height of the building. Under the provisions of these sections the following *minimum* sizes are prescribed for buildings not over the heights shown in table:

	AMOUNT OF INCREASE FOR EACH 12 FT. OF HEIGHT.	BUILDINGS 24-36 FEET IN HEIGHT.	BUILDINGS 36-48 FEET IN HEIGHT.	BUILDINGS 48-60 FEET IN HEIGHT.	BUILDINGS 60-72 FEET IN HEIGHT.	BUILDINGS 72-84 FEET IN HEIGHT.	BUILDINGS 84-96 FEET IN HEIGHT.
Outer courts, on lot line, width....	6 in.	5 ft.	5 ft. 6 in.	6 ft.	6 ft. 6 in.	7 ft.	7 ft. 6 in.
Outer courts, between wings, width.	1 ft.	10 ft.	11 ft. \	12 ft.	13 ft.	14 ft.	15 ft.

24. Describe intakes or ducts for each inner court (Sec. 63)
 Give size of each.
 Give area of each
25. State dimensions of windows for rooms (Sec. 68) *12 sq. ft. + over*
26. Will living rooms be provided with fan-lights over doors? *yes*
27. State dimensions of windows for bath-rooms and water-closet compartments (Sec. 69) *3 sq. ft. + over*
28. Will any part of the public halls be shut off from any other part of the public halls by doors? *no* If so, state how such portions will be lighted and ventilated (Sec. 72)
29. State size of ventilating skylight over main stairs (Sec. 83) *4'0" x 6'0"*
 Area of glazed surface? *25 sq. ft.* Is it provided with fixed louvres and also ridge ventilators? *yes*
30. Will cellar or basèment be occupied for living purposes; and state whether it is the cellar or the basement that is to be occupied? (Sec. 91) *no*

 Give height of such occupied rooms from finished floor to finished ceiling. ...
 Give height of ceiling of such rooms above the surface of the street or ground adjoining; and state whether it is the street or the yard.
31. How will the cellar or lowest floor be made damp-proof? (Sec. 92) *concrete + cement*
 What is the character of the ground or soil? *sand*
 How will the walls of the cellar or lowest floor be made damp-proof? *tar + asphalt*
32. How will the cellar ceiling be constructed? If not fireproof, will it be plastered? (Sec. 101) *fireproof + plastered*
33. How many water-closets, baths and other plumbing fixtures will be provided? (Sec. 95.)

	Cellar	Basement	1st Story	2d Story	3d Story	4th Story	5th Story	6th Story	7th Story	8th Story	9th Story	Total
Water-closets (how many)	4	—	4	4	4	4	4	4				28
Urinals,			2	4	4	4	4	4				22
Wash-basins,			2	4	4	4	4	4				22
Bath-tubs,			2	4	4	4	4	4				22
Shower-baths,			2	4	4	4	4	4				22
Wash-tubs,			2	4	4	4	4	4				22
Sinks,	4	—	6	4	4	4	4	4				30

34. Is the street on which building is proposed to be erected now provided with a public sewer? *yes* If not, what disposition will be made of waste and sewage?
35. If water-closets or bath-rooms are ventilated by means of a vent-shaft, give dimensions of same (Sec. 85) feet wide by feet long. Will vent-shafts be entirely open at the top? Describe intake for vent-shaft. Give size of same.

TENEMENT HOUSE DEPARTMENT OF THE CITY OF NEW YORK.

MANHATTAN.
Office: No. 61 Irving Place,
S. W. Cor. 18th Street,
BOROUGH OF MANHATTAN.

Tenement House Department
of the City of New York.

BROOKLYN, QUEENS AND RICHMOND
Office: Temple Bar Building,
44 Court Street,
BOROUGH OF BROOKLYN.

Received... APR. 22 1902 190

Borough of Manhattan

The City of New York, April 22 1902

Amendment to Plans and Application No. 10 U.B. 1902

Location 226-238 E. 14th St

5 The buildings will be arranged as shown on amended plans filed herewith, and the schedule of unoccupied space, computed at level of 2nd tier, will be as follows:-

Outer Court # 1,	6'-6" x 66'-11" =	434'-138" ✓
" " # 2,	6'-6" x 67'-3" =	437'-18" ✓
" " " # 1,	3'-0" x 7'-0" =	21'-0" ✓
" " " # 2,	2'-6" x 6'-0" =	15'-0" ✓
Rear Yard,	46'-4 1/2" x 13'-0" =	602'-126" ✓
Total unoccupied space =		1510'-138" ✓
Size of Lot =	46'-4 1/2" x 103'-3" =	4788'-31" ✓
" " Bldg.	46'-4 1/2" x 90'-3" =	3277'-37" ✓
Per. cent of Lot occupied		68.4% ✓

Number of Rooms, Apartments etc. will be as follows:-

No. of Rooms	1 st 9,	2 nd 20,	3 rd 20,	4 th 20,	5 th 20,	6 th 20,	Total
" " W.C. (cellar compartments)	2,	2,	0,	0,	0,	0,	4
" " rooms out of outer courts	6,	13,	13,	13,	13,	13,	71

Other rooms etc. as in original application.

Number of fixtures, etc. will be as follows

W. C.	cellar 2,	1 st 4,	2 nd 4,	3 rd 4,	4 th 4,	5 th 4,	6 th 4,	Total
Sinks	5,	6,	4,	4,	4,	4,	4,	31

Other fixtures as in original application.

The roof of ~~the~~ store extensions in courts will be level with 2nd floor, + skylights will be 2'-0" high to ridge, no louvers.

The stairs + platforms + stair halls will be at least 3'-0" wide in the clear.

See + small size

36. How will water-closet compartments be lighted and ventilated? (Sec. 95)
Give source of light. *windows to court; Gas*

37. How will floors of water-closet compartments be made water-proof? (Sec. 95)
slate or tile Will there be a base 6 inches high of water-proof material around same, and state of what material?
yes; slate or marble

38. Describe location and character of water supply for each apartment (Sec. 94).
sink etc. in each apartment
Will there be a roof tank? *yes*

39. What part of the building will be used as a store, or for any business purpose?
(Sec. 110). *front part of 1st story + cellar*

40. Remarks

Received July 10 1902

TENEMENT HOUSE DEPARTMENT OF THE CITY OF NEW YORK.

PLAN No. 10 of 1902.

Benjamin Weisberg
says: That he resides at Number 232 E. 10th Street

in the Borough of Manhattan
in the City of New York, in the County of New York,
in the State of New York, that he is ^{owner} the owners in fee of all that certain
lot, piece or parcel of land, situate, lying and being in the Borough of Manhattan
in the City of New York, aforesaid, and known and designated as Number 226-238
E. 14th Street, and hereinafter more particularly described;

that the work proposed to be done upon the said premises, in accordance with the accompanying
detailed statement in writing of the specifications and plans of such proposed work, to wit: Plan
No. 10 of 1902, is duly authorized to be performed by
said owner

and that Sass + Swallheiser, architects, are
duly authorized by him to make application in compliance with Chapters 344 and 466 of the Laws
of 1901, for the approval of such detailed statement of specifications and plans in his behalf.

The said land and premises above referred to, are situate at, bounded and described as
follows, viz.:

BEGINNING at a point on the southerly side of E. 14th
Street, distant 139 feet
westerly from the corner formed by the intersection of
Second Ave and E. 14th
Street running thence southerly 103'-3" feet;
thence westerly 185'-6" feet;
thence wortherly 103'-3" feet;
thence easterly 185'-6" feet
to the point or place of beginning.

[SIGNED] Benjamin Weisberg

THIRD AVENUE

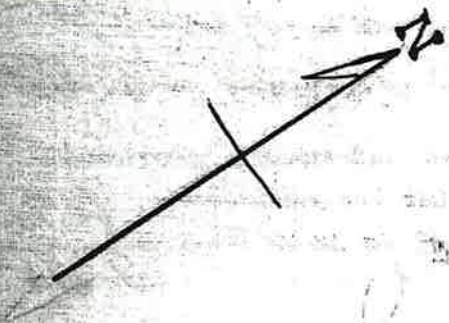

14TH STREET

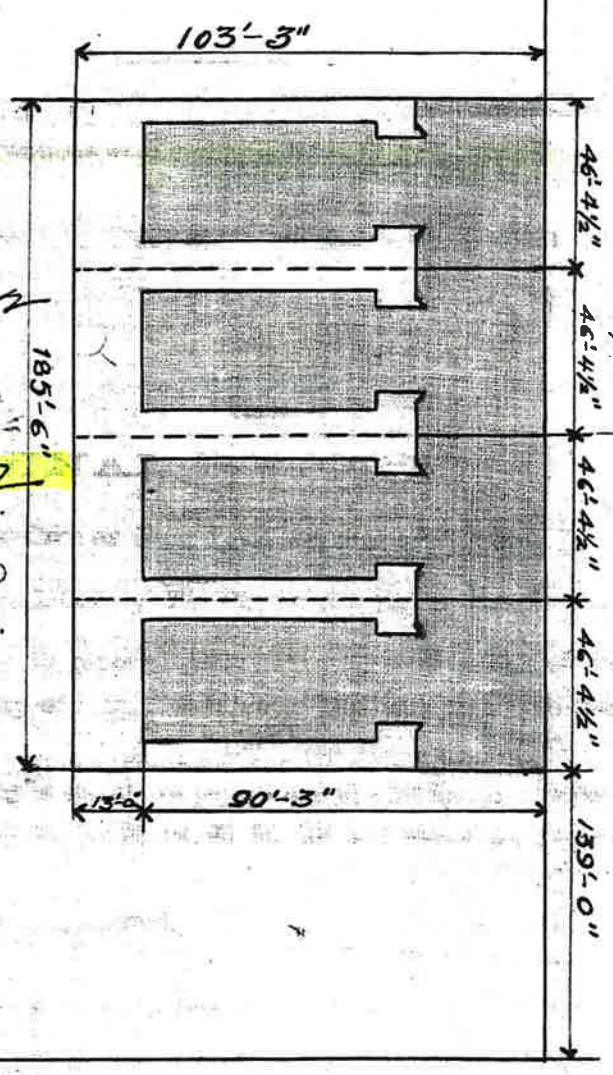

City House Department
 of the City of New York,
 received *Sept. 10, 1902*
 Plan No. **1902**
 SHEETS FILED

2

is
of
re

*Examiner
Chry*

SECOND AVENUE