

No. 273

Original

B 451  
L 47

Department for the Survey and Inspection of Buildings,

OFFICE No. 2 FOURTH AVENUE.

New York, March 15<sup>th</sup> 1869

PLAN AND SPECIFICATION.

INFORMATION REQUIRED IN RECORDING PLANS AND SPECIFICATIONS FOR THE ERECTION OF BUILDINGS.

1. Number of buildings to be erected, one
2. Location, street number, or side of street, and number of feet from nearest corner, No. 329 East Ninth Street, betw. 1<sup>st</sup> & 2<sup>nd</sup> Avenues, North side
3. Size of lot, 16 1/2 feet front, 16 1/2 feet rear, 100 feet deep.
4. Size of building, 16 1/2 feet front, 16 1/2 feet rear, 50 feet deep, 45 feet in height, from curb level to highest point. Number of stories in height, 4, base & cellars
5. Estimated value of the materials and labor required in the erection of each building, \$ 8000<sup>00</sup>
6. Depth of foundation from curb level or surface of ground (in no case to be less than four feet, except when laid upon solid rock), ten feet
7. Size of base stones, and how laid, 3 ft 6" by 20" & 8" thick
8. Thickness of foundation walls and piers, of what materials, and how laid; footing courses, timber or piles 20" blue stone walls
9. Thickness of upper walls, of what materials, and how laid, 12" brick walls

Extract from Law. "The mortar used in the construction of any building shall be composed of lime or cement mixed with sand, in proper proportions; no inferior lime or cement shall be used, and all sand shall be clean sharp grit, free from loam, and all the joints in all walls must be filled with mortar."

10. Materials of front. If stone, state the kind, give thickness of ashlar and backing, Philadelphia front bricks  
(All backing to be not less than 12 inches thick, and must be laid up with cement mortar.)
11. Materials of roofing, Tin
12. Materials of cornices, galvanized Iron
13. Iron shutters, none
14. Style of roof. Flat, Peak, or Mansard, flat
15. Access to roof, scuttle stairs How ventilated, ventilators
16. Independent walls, none thickness of, \_\_\_\_\_ inches.
17. Party-walls, both side walls thickness of, 12 inches.
18. Walls coped; what material, with blue stone
19. Sizes of floor beams; 1st tier, 3x9 inches; 2d tier, 3x9 inches; 3d tier, 3x9 inches; 4th tier, 3x8 inches; 5th tier, 3x8 inches; 6th tier, \_\_\_\_\_ inches; roof tier, 3x8 inches; material, Pine or Spruce distance from centres, 16"
20. Girders under floor beams, if any; size of same, of what materials, and how supported, none

21. Distance of wood-work from all flues, 8 inches ("not less than eight inches") from inside.
22. Hoistways, if any; how protected, none
23. Headers and trimmers to be hung in stirrup irons, none
24. How the building is to be occupied; if for a dwelling, state the number of families; if for a store or other business purposes in part, and the remainder for families, give the number on each floor, and whole number of families in each house, by two families.

25. Heights of ceilings, 1st story, 10 ft.; 2d story, 10 ft.; 3d story, 9 ft.; 4th story, 8 1/2 ft.; 5th story, \_\_\_\_\_ ft.; 6th story \_\_\_\_\_ ft.

26. Fire-escape, none

27. Wood-houses, if any; where located, and of what materials constructed, none

28. Hot air, steam, or other furnaces, if any, none

29. If the front, rear, or side walls are to be supported, in whole or in part, by iron girders or lintels, give definite particulars, none

Extract from Law. "All cast-iron girders, lintels, or columns, before used in any building, shall have the maximum weight they will safely sustain stamped or marked thereon."

30. Size of piers; how built, \_\_\_\_\_

Extract from Law. "That every isolated brick pier less than six superficial feet at the base, shall have a bond stone not less than four inches thick by full size of pier built therein, at intervals of not less than thirty inches; and all piers under ends of iron lintels or girders, or upon which iron or stone posts are to rest, whether isolated or not, shall be bonded as above stated, and have a cut granite cap on each, not less than twelve inches thick by full size of the pier."

31. If any walls already built are to be used as party-walls, fill up the application below.

#### APPLICATION TO USE PARTY-WALLS.

The undersigned gives notice that he intend to use the two side walls of building 8 No 327 & 331 E 9th Street as party-walls in the erection of the building described above, and respectfully requests that the same be examined and a permit granted therefor. The foundation walls are built of stone, 24 inches thick, the upper walls are built of bricks, 12 inches thick, 45 & 38 feet in height, 50 & 44 feet deep, \_\_\_\_\_

32. If there is any building on the front or rear of the lot, give description of the same, and state how occupied.

The present stable building on Lot will be taken down entirely.

33. That all materials and workmanship will be in accordance with the requirements of the law, yes

34. Give diagrams of floors in all cases,

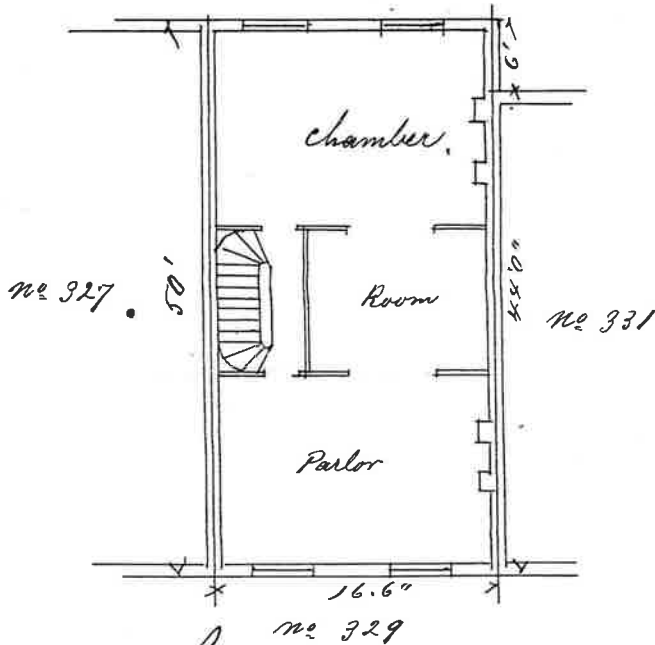

Owner Heis Residence 331 E 9th Street  
 Architect Wm. Gaul Residence 313 E 9th Street  
 Builder \_\_\_\_\_ Residence \_\_\_\_\_

REPORT ON APPLICATION.

New York, March 17<sup>th</sup> 1869

To the Superintendent of Buildings:

I respectfully report, that I have examined the wall named in the above application, and find the foundation wall to be built of stone, 12 inches thick; the upper wall brick, 12 inches thick 4.5 feet deep, 7.5 feet in height, and well in a good and safe condition to be used as proposed.

W. W. Adams  
 Deputy Superintendent of Buildings.

REMARKS.

No. 331 - The wall is 30 ft high + well set.

REPORT OF INSPECTOR.

New York, Nov 11<sup>th</sup> 1869

To the Superintendent of Buildings:

Work was commenced on the within described building on the 3<sup>rd</sup> day of June 1869 and completed on the 30<sup>th</sup> day of Oct 1869, and has been done in accordance with the plan and specification except as noted below.

Chas. K. Hyde

REMARKS.

Inspector.

*Original*  
PLANS AND SPECIFICATIONS

FOR

NEW BUILDINGS.

No. *273* Submitted *March 16, 1869*

LOCATION.

*229* *North* *St.*

Owner *John H. Lewis*

Architect *J. McKim*

Builder *John Schaeffer*

Referred to Deputy Supt. *March 16, 1869*

Returned by Deputy Supt. *18 1869*

Report *—* favorable.

*New York, March 18, 1869*

This is to Certify that I have examined the within plan and specification, and find the same to be in accordance with the several laws relating to buildings in the City of New York; and that the same has been entered in the records of this Department.

*Wm. M. ...*  
Superintendent of Buildings.

Referred to Inspector *...*

*March 18*

Returned *Nov 11, 1869*

*Chas. Spades*  
Inspector.

[SUPPLEMENT.]

All Tenement Houses having Stores on the first floor, and built to contain two or more families on a floor above the store, the ceiling above the store must be constructed as follows:

Lathed with iron lath throughout, or deafened with good mortar not less than one inch thick, and leveled with the top of the beams; and, if the deafening is used instead of the iron lath, then there must be in addition to the deafening, a space lathed with iron lath not less than two feet wide, against all walls that are furred; and in all cases where iron lath is used on any ceiling, it must be let into the horizontal joints of the brick walls not less than one-half inch. All hall partitions in such buildings must be either 8-inch walls built from the foundation to the top of the second story beams; or, if the partitions are built of wooden ~~boards~~, the partitions must be filled in with brick or lathed with iron lath on the hall side of the partition. All wood-houses placed in the cellars of tenement buildings must be constructed fire-proof.

In all new buildings that require fire-escapes, the iron brackets or bearers for the fire-escape must be built into the walls as the building of the wall progresses, and the fire-escape completely finished before the building is occupied.

Inspectors are required to report forthwith any person or persons violating any of the foregoing provisions.

JAS. M. MACGREGOR,

*Supt. of Buildings.*