

99
Original
Department for the Survey and Inspection of Buildings, 1

OFFICE, No. 2 FOURTH AVENUE.

New York, Sept. 15th 1869

B
L 34

35

PLAN AND SPECIFICATION.

36

INFORMATION REQUIRED IN RECORDING PLANS AND SPECIFICATIONS FOR THE ERECTION OF BUILDINGS.

1. Number of buildings to be erected, Four
2. Location, lot number, or side of street, and number of feet from nearest corner, North west corner of First Avenue & Fifth Street
3. Size of lot, 50 feet front, 50 feet rear, 125 feet deep.
4. Size of building, 50 feet front, 50 feet rear, 125 feet deep, 52 feet in height, from curb level to highest point. Number of stories in height, five, Corner House General Roof
5. Estimated value of the materials and labor required in the erection of each building, \$ 14,000 - 56,000
6. Depth of foundation from curb level or surface of ground (in no case to be less than four feet, except when laid upon solid rock), ten feet
7. Size of base stones, and how laid, 3 ft 8 in by 2 ft & 10 in thick
8. Thickness of foundation walls and piers, of what materials, and how laid; footing courses, timber or piles 20 in Brick masonry & 2 ft blue stone
9. Thickness of upper walls, of what materials, and how laid, 16 in & 12 in brick

Extract from Law. "The mortar used in the construction of any building shall be composed of lime or cement mixed with sand, in proper proportions; no inferior lime or cement shall be used, and all sand shall be clean sharp grit, free from loam, and all the joints in all walls must be filled with mortar."

10. Materials of front. If stone, state the kind, give thickness of ashlar and backing, Philadelphia Front Bricks, cast iron sills & rustals
(All backing to be not less than 12 inches thick, and must be laid up with cement mortar.)
11. Materials of roofing, Tin
12. Materials of cornices, galvanized iron
13. Iron shutters, no
14. Style of roof. Flat, Peak, or Mansard, flat & Corner House Mansard
15. Access to roof, Bullhead. How ventilated, Ventilation in
16. Independent walls, independent thickness of, 16 & 12 inches.
17. Party-walls between houses thickness of, 16 & 12 inches.
18. Walls coped; what material, blue stone
19. Sizes of floor beams; 1st tier, 3x10 inches; 2d tier, 3x10 inches; 3d tier, 3x9 inches; 4th tier, 3x9 inches; 5th tier, 3x9 inches; 6th tier, _____ inches; roof tier, 3x9 inches; material, 16 & 20 distance from centres, _____
20. Girders under floor beams, if any; size of same, of what materials, and how supported, 10 x 11 supported by Locust & Iron posts

21. Distance of wood-work from all flues, 8 inches ("not less than eight inches") from inside.
22. Hoistways, if any; how protected, _____
23. Headers and trimmers to be hung in stirrup irons, _____ Corner House
24. How the building is to be occupied; if for a dwelling, state the number of families; if for a store or other business purposes in part, and the remainder for families, give the number on each floor, and whole number of families in each house, eight families above first floor stores below

25. Heights of ceilings, 1st story, 12 ft.; 2d story, 9 1/2 ft.; 3d story, 8 1/2 ft.; 4th story, 8 1/2 ft.; 5th story, 8 1/2 ft.; 6th story _____ ft.

26. Fire-escape, escape as per Law

27. Wood-houses, if any; where located, and of what materials constructed, as per Law & under Paints

28. Hot air, steam, or other furnaces, if any, _____

29. If the front, rear, or side walls are to be supported, in whole or in part, by iron girders or lintels, give definite particulars, Iron Lintel Course & posts 12 by 12 in & strong arches inside

Extract from Law. "All cast-iron girders, lintels, or columns, before used in any building, shall have the maximum weight they will safely sustain stamped or marked thereon."

30. Size of piers; how built, of brick work & blue stone & granite caps

Extract from Law. "That every isolated brick pier less than six superficial feet at the base, shall have a bond stone not less than four inches thick by full size of pier built therein, at intervals of not more than thirty inches; and all piers under ends of iron lintels or girders, or upon which iron or stone posts are to rest, whether isolated or not, shall be bonded as above stated, and have a cut granite cap on each, not less than twelve inches thick by full size of the pier."

31. If any walls already built are to be used as party-walls, fill up the application below.

APPLICATION TO USE PARTY-WALLS.

The undersigned gives notice that we intend to use the party wall of building 341 E 5th St as party-wall in the erection of the building described above, and respectfully requests that the same be examined and a permit granted therefor. The foundation wall built of stone, 20 inches thick; the upper wall 16 built of brick, inches thick, 52 feet in height, 10 feet deep, _____

Jessner & Co

32. If there is any building on the front or rear of the lot, give description of the same, and state how occupied. None

33. That all materials and workmanship will be in accordance with the requirements of the law, Yes

34. Give diagrams of floors in all cases.

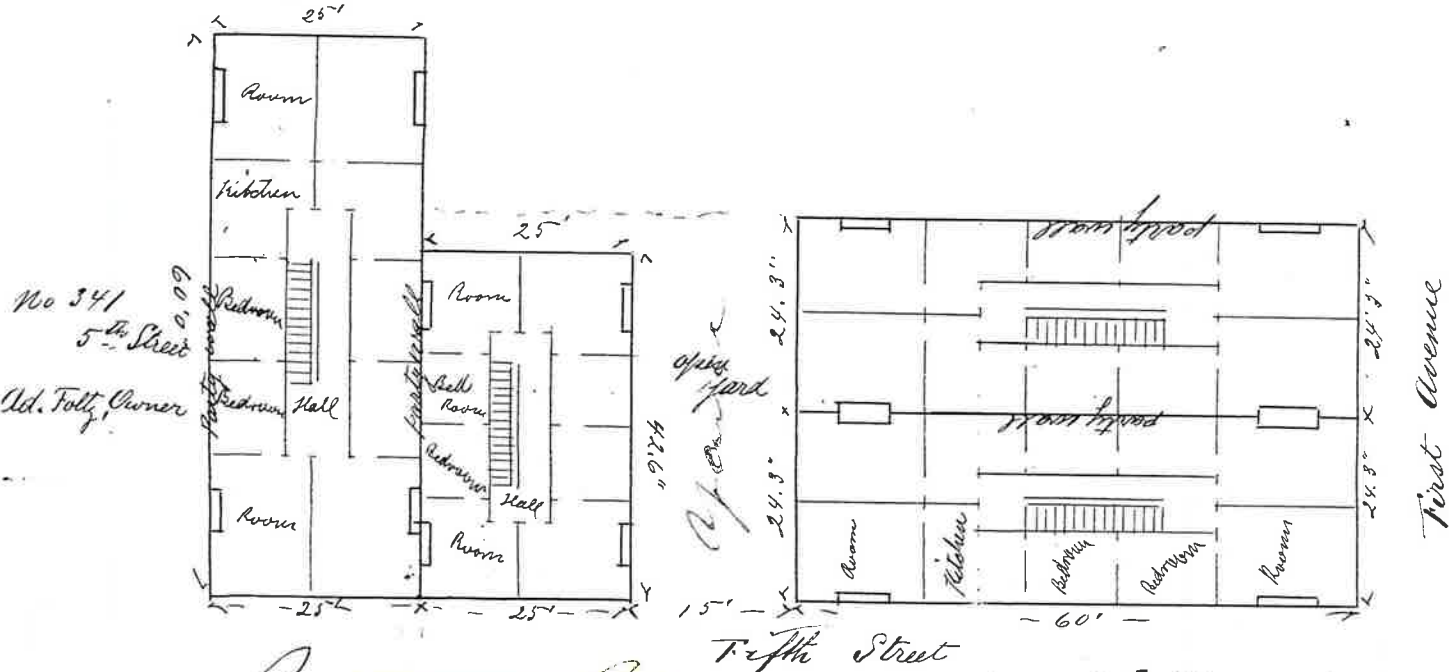

Owner Jessner & Co Residence E. 16th St 1st Av.
 Architect Geo. B. Winger Residence 58 B'way
 Builder Jessner & Co Residence E. 16th St 1st Av.

REPORT ON APPLICATION.

New York, Sept 16th 1869

To the Superintendent of Buildings:

I respectfully report, that I have examined the wall named in the above application, and find the foundation wall to be built of brick 20 inches thick; the upper wall built of brick, 12 inches thick 50 feet deep, 50 feet in height, and — in a good and safe condition to be used as proposed.

W. H. ...
Deputy Superintendent of Buildings.

REMARKS.

REPORT OF INSPECTOR.

New York, Dec 20 1869

To the Superintendent of Buildings:

Work was commenced on the within described building on the 22 day of Sept 1869 and completed on the 12 day of Feb 1870, and has been done in accordance with the plan and specification except as noted below.

Chas. K. Hyzer
Inspector.

REMARKS.

These buildings are connected by iron doors in the party walls on each story. Finished without violation.
Hyde
C. K. H.

DEPARTMENT OF HOUSING AND BUILDINGS
 DEPARTMENT OF
BOROUGH OF HOUSING & BUILDINGS CITY OF NEW YORK

NOTICE—This application must be typewritten and filed in quadruplicate. All proposed work under this application must be shown on plans and sections. Vertical lines of soil, waste, leader and refrigerator pipes should be designated by numbers or letters. A soil or waste line and its attendant vent line may be considered as one stack, and so numbered or lettered. In alterations, **NEW WORK ONLY** should be specified. When new fixtures are to be connected to present lines, the location and diameter of said lines must be shown on the plan. Minor alterations in connection with work described may be included in this form.

PLUMBING, MECHANICAL EQUIPMENT AND TANK INSTALLATION

APPLICATION No. 1940 BLOCK 447 LOT 36
 Street No. and LOCATION 345 East 5th Street, New York City

FEES REQUIRED FOR B.M. N.B. AET. No. 4415 194 0

Owner Annie Levenson Address 225 Eastern Parkway, Brooklyn, N. Y.
 Lessee _____
 Agent _____

Licensed Plumber Samuel Dickstein Address 312 East 8th Street

COMPENSATION INSURANCE has been secured in accordance with the requirements of the Workmen's Compensation Law as follows:

To The Borough Superintendent: _____ City of New York, _____, 19____
 Application is hereby made on behalf of the owner/lessee for approval of the plans and specifications herewith submitted, and made a part hereof, for the erection, alteration or installation of the building therein described,—with the understanding that if no work is performed hereunder within one year from the time of issuance, this approval shall expire by limitation as provided by law; and the applicant agrees to comply with the Building Code and all rules and regulations applicable thereto in effect at this date.

Applicant (Sign Here) Samuel Dickstein Address 312 East 8th Street

Work Included Herein: Plumbing? Yes Sprinkler? No Standpipe? No Fuel Oil? No

1. State in detail the work proposed. Install new water closets for each apartment as required by M. D. L.

Is this a new or old building? old
 If old building, give character of construction ordinary Class: 3
 Dimensions: Stories High 6 Feet High 65 Feet Front 25 Feet Deep 52
 How occupied Old Law Tenement, Class "A" M. D. & stores No. of Families 10
 Is application made to remove a violation or order of any Dept.? Yes Give No. Housing Division
 How to be occupied Same
 Estimated Cost \$1,000

PLUMBING SPECIFICATIONS

Describe special equipment or features: _____

Sewage and Drainage Disposal: Combined Yes Sanitary No Storm No Cesspool No
 How will flushometers be water supplied? From a street pressure, pressure tank or roof tank? None

Will building be piped for gas? No Describe purpose _____

Air Conditioner None How will waste be disposed of? _____

Table of fixtures to include fixtures reset where new roughing is installed.

Indicate Number of Proposed Fixtures on All Floors																				DESCRIBE FIXTURES				
	Collar	Basement	First Floor	Second	Third	Fourth	Fifth	Sixth	Seventh	Eighth	Ninth	Tenth	Eleventh	Twelfth	Thirteenth	Fourteenth	Fifteenth	Sixteenth	Seventeenth		Eighteenth	Nineteenth	Twentieth	
Water-Closets			2	2	2	2	2																	syphon action washdown
Urinals																								Flush tank, app'd vac. breakers
Wash-basins																								
Bath-tubs			2	2	2	2	2																	iron enamel
Wash-tubs			2	2	2	2	2																	" "
Sinks			2	2	2	2	2																	" "
Dental Cupboards																								
Slop Sinks																								
Drinking Fountains																								1-4" Soil } cast iron 1-3" Vent }
Showers																								

EXISTING SINK & TUB TO BE RELOCATED ON FIRST FLOOR NEW COMB. SINK & TRAY ON UPPER FLOORS

Minimum Water Pressure
 At Curb Elevation is _____ lbs. Sq. In
 NOTE: Obtain from Department
 of Water Supply, Gas and
 Electricity a certificate stating
 the water pressure at the curb.

Approximate depth is _____ feet to inner top of
 Existing _____ Proposed _____ Combined Sewer _____
 Existing _____ Proposed _____ Sanitary Sewer _____
 Existing _____ Proposed _____ Storm Sewer _____
 from legal grade of street.

Bureau of Sewers

STANDPIPE AND SPRINKLER SPECIFICATIONS

State proposed work _____
 Is building equipped with any other fire-extinguishing system than that proposed? If so, give description: _____
 Supply:—

- a: Gravity Tank:
 Total capacity _____ gallons. Fire reserve _____ gallons.
 Height above main roof _____ feet, above penthouse roof _____ feet.
- b: Intermediate Tank:
 Capacity _____ gallons. Location _____ (story)
- c: Pressure Tank:
 Capacity _____ number of gallons. Air compressor _____
- d: Street Main Connections:
 Number _____ minimum water pressure at curb _____ pounds.
- e: Fire Pump _____ G.P.M. Capacity. Suction Tank _____ gallons.

If an alteration or extension to an existing approved system, give date of approval, plan number and plan showing connections to the source of supply.

FUEL OIL SPECIFICATIONS

- 1. Baume _____ FLASH POINT _____ No. of Tanks _____
- 2. Capacity of each tank _____ LOCATION _____ Foundation _____
- 3. Name of burner _____ B. S. & A. Approval No. _____
- 4. Location of remote control _____ Number of approved fire extinguishers _____
- 5. Fire retarding _____

SKETCH SHOWING PLOT DIAGRAM AND LOCATION OF TANK FOR ONE AND TWO FAMILY DWELLINGS MAY BE DRAWN HERE:—

FUEL OIL OR GASOLINE TANK INSTALLATIONS

Examined and Recommended
 for Approval on _____

1/7/41 19
 JAN 8 - 1941 19
J. Lynch
 Examiner

APPROVED _____

Borough Superintendent

REMARKS: