

BOROUGH OF MANHATTAN, CITY OF NEW YORK

**RICHMOND**  
Boro Hall,  
St. George, S. I.

# DEMOLITION

Borough Superintendent.

Wrecker Harry A. Biesantz Co., Inc. Address 565 Fifth Avenue N. Y. C.

STATE AND CITY OF NEW YORK, }  
COUNTY OF N. Y. } ss.:

Harry A. Biesantz being duly sworn deposes and says that  
he resides at 565 Fifth Avenue and  
has been fully authorized to file this demolition notice by

Dept. of Housing & Buildings Municipal Building N. Y. C.  
(Name) (Address)

Owner by precept  
who is the (Owner, Etc.) of  
the building to be demolished as herein prescribed and said Owner  
consent to the demolition has been obtained by me and that all statements contained in this application are true and correct.

Sign here, with full name Harry A. Biesantz Co. Inc.  
(Applicant)  
Harry A. Biesantz  
(If a corporation, name and title of officer signing)  
565 Fifth Avenue N. Y. C.  
(Address)

Sworn to before me this  
11 day of Sept, 1942  
Notary Public or Commissioner of Deeds

Referred to U. B. Clerk on 19 ,  
for report, stating all pending unsafe building cases against the property covered by this notice, and all unpaid bills for  
emergency work or survey and search fees, if any.  
U. B. 979/42 Pending Survey  
fee of \$25.00 due.  
(Dated) (Signed) E. Cestaro

Referred to Inspector on 19 ,  
for supervision, and FINAL REPORT when work has been completed.  
DEMOLITION COMMENCED 19  
DEMOLITION COMPLETED 19  
(Dated) (Signed) Inspector District.

## DEPARTMENT OF HOUSING AND BUILDINGS

BOROUGH OF

, CITY OF NEW YORK

MANHATTAN  
Municipal Bldg.,  
ManhattanBROOKLYN  
Municipal Bldg.,  
BrooklynBRONX  
Bronx County Bldg.,  
Grand Concourse & E. 161st St.QUEENS  
21-10 49th Avenue  
L. I. CityRICHMOND  
Boro Hall,  
St. George, S. I.

NOTICE—This Application must be filed in quadruplicate

DEMOLITION  
(N.B., Alt. Etc.)

APPLICATION No.

124

LOCATION

420 E. 11 St

## PLOT DIAGRAM

OWNER

Address

ARCHITECT

Address

SIZE OF LOT feet front feet side feet rear feet side

AREA OF LOT square feet Percentage of lot occupied %

The lot lines and exterior walls of the building must be drawn to indicated scale. Show dimensions of lot, building, courts and yards.

The following information must be obtained from the departments and bureaus concerned and verified by them. A diagram must be made showing the correct street lines from the city plan; the plot to be built upon in relation to the street lines and the portion of the lot to be occupied by the building; the legal grades of streets at nearest points from the proposed buildings in each direction; the house numbers; and the Block, Lot, Section and Volume numbers. The data for the above may be obtained from the Bureau of Highways, and the Tax Department.

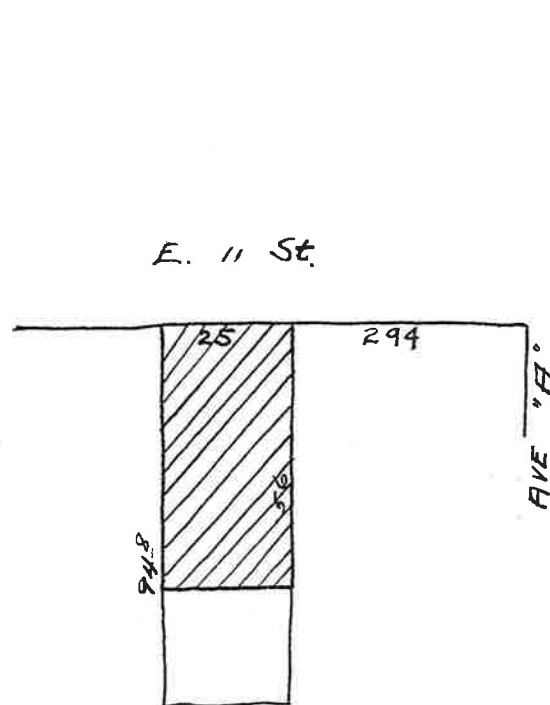

N.

The north point  
of the diagram must  
agree with the arrow