

1272-1908

28 B-1-07 (B)-Form No. 2-1907.

ORIGINAL

Applicant must indicate the Building Line of Lines clearly and distinctly on the Drawings.

B400  
L46

Office of the Borough President of the Borough of Manhattan,

In The City of New York.

THE BUREAU OF BUILDINGS FOR THE BOROUGH OF MANHATTAN,

Office, No. 220 FOURTH AVENUE,

S. W. Corner 18th Street.

BUREAU OF BUILDINGS  
RECEIVED JUL 1 1908  
OFFICE OF THE BOROUGH  
PRESIDENT OF THE BOROUGH  
OF MANHATTAN

Plan No.                     

### APPLICATION TO ALTER, REPAIR, ETC.

Application is hereby made to the Superintendent of Buildings of The City of New York, for the Borough of Manhattan, for the approval of the detailed statement of the specifications and plans herewith submitted, for the alteration or repairs of the building herein described. All provisions of the Law shall be complied with in the alteration or repair of said building, whether specified herein or not.

(Sign here)

*[Signature]*  
The City of New York, Borough of Manhattan, June 19th 1908

#### LOCATION AND DESCRIPTION OF PRESENT BUILDING.

- State how many buildings to be altered One
- What is the exact location thereof? (State on what street or avenue, the side thereof, the number of feet from the nearest street or avenue, and the name thereof)  
# 319 East 10th Street
- How was the building occupied? Tenement  
How is the building to be occupied? Tenement
- Is the building on front or rear of lot? Front Is there any other building erected on lot or permit granted for one? None Size            x           ; height            How occupied?            Give distance between same and proposed building            feet.
- Size of lot? 25'-0" feet front; 25'-0" feet rear; 91'-6" feet deep.
- Size of building which it is proposed to alter or repair? 25'-0" feet front; 25'-0" feet rear; 40'-0" feet deep. Number of stories in height? Cellar, Basement & 4 stories Height from curb level to highest point? 51'-6"
- Depth of foundation walls below curb level? 12'-6" Material of foundation walls? Blue Stone Thickness of foundation walls? front 16 inches; rear 16 inches; side 16 inches; party 16 inches.
- Material of upper walls? Brick If ashlar, give kind and thickness None
- Thickness of upper walls:  
Basement: front 12 inches; rear 12 inches; side 12 inches; party 12 inches.  
1st story: " 12 " " 12 " " 12 " " 12 "  
2d story: " 12 " " 12 " " 12 " " 12 "  
3d story: " 12 " " 12 " " 12 " " 12 "  
4th story: " 12 " " 12 " " 12 " " 12 "  
5th story: "            " "            " "            " "            "  
6th story: "            " "            " "            " "            "
- Is roof flat, peak or mansard? Flat

*(No Plumbing)*

11. Size of present extension, if any? \_\_\_\_\_ feet front; \_\_\_\_\_ feet deep; \_\_\_\_\_ feet high.
12. Thickness and material of foundation walls? \_\_\_\_\_
13. Material of upper walls? \_\_\_\_\_ If ashlar, give kind and thickness \_\_\_\_\_
14. Thickness of upper walls:  
 Basement: front \_\_\_\_\_ inches; rear \_\_\_\_\_ inches; side \_\_\_\_\_ inches; party \_\_\_\_\_ inches.  
 1st story: " \_\_\_\_\_ " \_\_\_\_\_ " \_\_\_\_\_ " \_\_\_\_\_ " \_\_\_\_\_ " \_\_\_\_\_ "  
 2d story: " \_\_\_\_\_ " \_\_\_\_\_ " \_\_\_\_\_ " \_\_\_\_\_ " \_\_\_\_\_ " \_\_\_\_\_ "  
 3d story: " \_\_\_\_\_ " \_\_\_\_\_ " \_\_\_\_\_ " \_\_\_\_\_ " \_\_\_\_\_ " \_\_\_\_\_ "  
 4th story: " \_\_\_\_\_ " \_\_\_\_\_ " \_\_\_\_\_ " \_\_\_\_\_ " \_\_\_\_\_ " \_\_\_\_\_ "

15. Is present building provided with a fire escape? Yes

If to be extended on any side, give the following information:

16. Is extension to be on side, front or rear? \_\_\_\_\_
17. Size of proposed extension, feet front \_\_\_\_\_; feet rear \_\_\_\_\_; feet deep \_\_\_\_\_; number of stories in height? \_\_\_\_\_ number of feet in height? \_\_\_\_\_
18. Material of foundation walls? \_\_\_\_\_; depth \_\_\_\_\_ feet; material of base course \_\_\_\_\_; thickness of base course \_\_\_\_\_; thickness of foundation walls, front \_\_\_\_\_ inches; side \_\_\_\_\_ inches; rear \_\_\_\_\_ inches; party \_\_\_\_\_ inches.
19. Will foundation be on rock, sand, earth or piles? \_\_\_\_\_
20. What will be the size of piers in cellar? \_\_\_\_\_; distance on centres? \_\_\_\_\_; size of base of piers? \_\_\_\_\_; thickness of cap stones? \_\_\_\_\_; of bond stones? \_\_\_\_\_
21. Material of upper walls? \_\_\_\_\_; material of front? \_\_\_\_\_
22. Thickness, exclusive of ashlar, of upper walls:  
 1st story: front \_\_\_\_\_ inches; rear \_\_\_\_\_ inches; side \_\_\_\_\_ inches; party \_\_\_\_\_ inches.  
 2d story: " \_\_\_\_\_ " \_\_\_\_\_ " \_\_\_\_\_ " \_\_\_\_\_ " \_\_\_\_\_ " \_\_\_\_\_ "  
 3d story: " \_\_\_\_\_ " \_\_\_\_\_ " \_\_\_\_\_ " \_\_\_\_\_ " \_\_\_\_\_ " \_\_\_\_\_ "  
 4th story: " \_\_\_\_\_ " \_\_\_\_\_ " \_\_\_\_\_ " \_\_\_\_\_ " \_\_\_\_\_ " \_\_\_\_\_ "  
 5th story: " \_\_\_\_\_ " \_\_\_\_\_ " \_\_\_\_\_ " \_\_\_\_\_ " \_\_\_\_\_ " \_\_\_\_\_ "  
 6th story: " \_\_\_\_\_ " \_\_\_\_\_ " \_\_\_\_\_ " \_\_\_\_\_ " \_\_\_\_\_ " \_\_\_\_\_ "
23. With what will walls be coped? \_\_\_\_\_
24. Will roof be flat, peak, or mansard? \_\_\_\_\_; material \_\_\_\_\_
25. Give size and material of floor and roof beams  
 1st tier, material \_\_\_\_\_; size \_\_\_\_\_; distance on centres \_\_\_\_\_  
 2d tier, " \_\_\_\_\_ " \_\_\_\_\_ " \_\_\_\_\_ " \_\_\_\_\_ "  
 3d tier, " \_\_\_\_\_ " \_\_\_\_\_ " \_\_\_\_\_ " \_\_\_\_\_ "  
 4th tier, " \_\_\_\_\_ " \_\_\_\_\_ " \_\_\_\_\_ " \_\_\_\_\_ "  
 5th tier, " \_\_\_\_\_ " \_\_\_\_\_ " \_\_\_\_\_ " \_\_\_\_\_ "  
 Roof tier, " \_\_\_\_\_ " \_\_\_\_\_ " \_\_\_\_\_ " \_\_\_\_\_ "
- Give thickness of headers \_\_\_\_\_ of trimmers \_\_\_\_\_
26. Give material of girders \_\_\_\_\_ of columns \_\_\_\_\_  
 Under 1st tier, size of girders \_\_\_\_\_; size of columns \_\_\_\_\_  
 " 2d " " " \_\_\_\_\_; " " \_\_\_\_\_  
 " 3d " " " \_\_\_\_\_; " " \_\_\_\_\_  
 " 4th " " " \_\_\_\_\_; " " \_\_\_\_\_  
 " 5th " " " \_\_\_\_\_; " " \_\_\_\_\_  
 " Roof tier, " " \_\_\_\_\_; " " \_\_\_\_\_

27. If front, rear or side is to be supported on columns or girders, give  
 girders, material \_\_\_\_\_ ; front \_\_\_\_\_ ; side \_\_\_\_\_ ; rear \_\_\_\_\_  
 size \_\_\_\_\_ " \_\_\_\_\_ " \_\_\_\_\_ " \_\_\_\_\_  
 columns, material \_\_\_\_\_ " \_\_\_\_\_ " \_\_\_\_\_ " \_\_\_\_\_  
 size \_\_\_\_\_ " \_\_\_\_\_ " \_\_\_\_\_ " \_\_\_\_\_
28. If constructed of frame, give material \_\_\_\_\_ ; size of sill \_\_\_\_\_ ;  
 plate \_\_\_\_\_ ; enterties \_\_\_\_\_ ; posts \_\_\_\_\_ ; studs \_\_\_\_\_ ;  
 braces \_\_\_\_\_
29. If open on one side, give size of plate \_\_\_\_\_ posts \_\_\_\_\_
30. How will extension be occupied? \_\_\_\_\_ If for  
 dwelling, give number of families on each floor \_\_\_\_\_
31. How will extension be connected with main building? \_\_\_\_\_
32. Give size of skylights \_\_\_\_\_ ; material \_\_\_\_\_
33. Give material of cornices \_\_\_\_\_
34. Give material of light shafts \_\_\_\_\_ ; size \_\_\_\_\_

If to be increased in height, give the following information :

35. Will building be raised from foundation, or extended on top? Give particulars \_\_\_\_\_  
 \_\_\_\_\_  
 \_\_\_\_\_
36. How many stories high will building be when raised? \_\_\_\_\_ ; feet high \_\_\_\_\_
37. Will the roof be flat, peak or mansard? \_\_\_\_\_ , material \_\_\_\_\_
38. Material of coping? \_\_\_\_\_
39. Give material of new walls \_\_\_\_\_ thickness of \_\_\_\_\_ story \_\_\_\_\_ inches ;  
 \_\_\_\_\_ story \_\_\_\_\_ inches ; \_\_\_\_\_ story \_\_\_\_\_ inches ; \_\_\_\_\_ story  
 \_\_\_\_\_ inches ; \_\_\_\_\_ story \_\_\_\_\_ inches ; \_\_\_\_\_ story \_\_\_\_\_ inches ;  
 \_\_\_\_\_ story \_\_\_\_\_ inches.
40. Material of floor beams? \_\_\_\_\_ Size \_\_\_\_\_ tier \_\_\_\_\_  
 centres \_\_\_\_\_ ; \_\_\_\_\_ tier \_\_\_\_\_ ; centres \_\_\_\_\_ ; \_\_\_\_\_ tier \_\_\_\_\_  
 centres \_\_\_\_\_ ; \_\_\_\_\_ tier \_\_\_\_\_ ; centres \_\_\_\_\_ ; \_\_\_\_\_ tier \_\_\_\_\_  
 centres \_\_\_\_\_
41. Material of girders? \_\_\_\_\_ Size under 1st tier \_\_\_\_\_ ;  
 2d tier \_\_\_\_\_ ; 3d tier \_\_\_\_\_ ; 4th tier \_\_\_\_\_ ; 5th tier \_\_\_\_\_ ;  
 6th tier \_\_\_\_\_
42. Material of columns? \_\_\_\_\_ Size under 1st tier \_\_\_\_\_ ; 2d tier \_\_\_\_\_ ;  
 3d tier \_\_\_\_\_ ; 4th tier \_\_\_\_\_ ; 5th tier \_\_\_\_\_ ; 6th tier \_\_\_\_\_
43. Size of piers in cellar \_\_\_\_\_ ; distance on centres \_\_\_\_\_ ; thickness of cap stones  
 to piers \_\_\_\_\_ ; bond stones \_\_\_\_\_
44. If constructed of frame, give material of frame \_\_\_\_\_ ; size of sills \_\_\_\_\_ ;  
 corner posts \_\_\_\_\_ ; middle posts \_\_\_\_\_ ; enterties \_\_\_\_\_ ; plates \_\_\_\_\_  
 braces \_\_\_\_\_ ; studs \_\_\_\_\_
45. How will building be occupied when altered? \_\_\_\_\_  
 If for dwelling, state number of families on each floor? \_\_\_\_\_  
 \_\_\_\_\_
46. With what kind of fire escape will building be provided? \_\_\_\_\_  
 \_\_\_\_\_

If the Front, Rear or Side Walls, or any portion thereof, are to be taken out and rebuilt, give definite particulars, and state in what manner :

47. I propose to remove present partition shown on plan in dotted lines & present wall where shown to be furried off.

If altered internally, give definite particulars, and state how the building will be occupied :

48. \_\_\_\_\_  
 \_\_\_\_\_  
 \_\_\_\_\_  
 \_\_\_\_\_  
 \_\_\_\_\_  
 \_\_\_\_\_  
 \_\_\_\_\_  
 \_\_\_\_\_

49. How much will the alteration cost? \$ 50.00 / 100

If the Building is to be occupied as a Flat, Apartment or Lodging House, give the following particulars :

50. Is any part of building to be used as a store or for any other business purpose, if so, state for what ?

	Cellar	Basement	1st Floor	2d Floor	3d Floor	4th Floor	5th Floor	6th Floor
51. How many families will occupy each ?	-	-						
52. Height of ceilings?	-	-	-	-				

53. How basement to be occupied? \_\_\_\_\_  
 How made water-tight? \_\_\_\_\_

54. Will cellar or basement ceiling be plastered? \_\_\_\_\_ How? \_\_\_\_\_

55. How will cellar stairs be enclosed? \_\_\_\_\_

56. How will cellar be occupied? \_\_\_\_\_  
 How made water-tight? \_\_\_\_\_

57. Will shafts be opened or covered with louvre skylights full size of shafts? \_\_\_\_\_  
 Size of each shaft? \_\_\_\_\_

58. Dimensions of water closet windows? \_\_\_\_\_  
 Dimensions of windows for living rooms? \_\_\_\_\_
59. Of what materials will hall partitions be constructed? \_\_\_\_\_  
 \_\_\_\_\_
60. Of what materials will hall floors be constructed? \_\_\_\_\_  
 \_\_\_\_\_
61. How will hall ceilings and soffits of stairs be plastered? \_\_\_\_\_
62. Of what material will stairways be constructed? \_\_\_\_\_  
 Give sizes of stair well holes? \_\_\_\_\_
63. If any other building on lot, give size; front \_\_\_\_\_; rear \_\_\_\_\_; deep \_\_\_\_\_;  
 stories high \_\_\_\_\_; how occupied \_\_\_\_\_; on front or rear  
 of lot \_\_\_\_\_; material \_\_\_\_\_.  
 How much space between it and proposed building? \_\_\_\_\_
64. How will floors and sides of water closets to the height of 16 inches be made waterproof? \_\_\_\_\_  
 \_\_\_\_\_
65. Number and location of water closets: Cellar \_\_\_\_\_; 1st floor \_\_\_\_\_; 2d floor \_\_\_\_\_;  
 3d floor \_\_\_\_\_; 4th floor \_\_\_\_\_; 5th floor \_\_\_\_\_; 6th floor \_\_\_\_\_;
66. This building will safely sustain per superficial foot upon the 1st floor \_\_\_\_\_ lbs.; upon 2d floor  
 \_\_\_\_\_ lbs.; upon 3d floor \_\_\_\_\_ lbs.; upon 4th floor \_\_\_\_\_ lbs.; upon 5th floor  
 \_\_\_\_\_ lbs.; upon 6th floor \_\_\_\_\_ lbs.; upon 7th floor \_\_\_\_\_ lbs.; upon 8th floor  
 \_\_\_\_\_ lbs.

Owner, Dr. Joel M. Chasin Address, 319 East 10th St

Architect, Henry Regelman " 133-7th Street

Superintendent, \_\_\_\_\_ " \_\_\_\_\_

Mason, \_\_\_\_\_ " \_\_\_\_\_

Carpenter, \_\_\_\_\_ " \_\_\_\_\_

If a Wall, or Part of a Wall already built is to be used, fill up the following:

THE CITY OF NEW YORK, BOROUGH OF MANHATTAN, \_\_\_\_\_ 190

The undersigned gives notice that \_\_\_\_\_ intend to use the \_\_\_\_\_ wall of building

\_\_\_\_\_ as party wall in the erection of the building hereinbefore described, and respectfully requests that the same be examined and a permit granted therefor. The foundation wall \_\_\_\_\_ built of \_\_\_\_\_ inches thick, \_\_\_\_\_ feet below curb; the upper wall \_\_\_\_\_ built of \_\_\_\_\_ inches thick, \_\_\_\_\_ feet deep, \_\_\_\_\_ feet in height.

(Sign here) \_\_\_\_\_

### REPORT UPON APPLICATION.

The Bureau of Buildings for the Borough of Manhattan.

The City of New York, Borough of Manhattan, \_\_\_\_\_ 190

To the Superintendent of Buildings for the Borough of Manhattan:

I respectfully report that I have thoroughly examined and measured the wall \_\_\_\_\_, etc., named in the foregoing application, and found the foundation wall \_\_\_\_\_ to be built of \_\_\_\_\_ inches thick, \_\_\_\_\_ feet below curb, the upper wall \_\_\_\_\_ built of \_\_\_\_\_ inches thick, \_\_\_\_\_ feet deep, \_\_\_\_\_ feet in height, and that the mortar in said wall \_\_\_\_\_ is \_\_\_\_\_ hard and good, and that the building \_\_\_\_\_ in a good and safe condition to be altered as proposed. The \_\_\_\_\_ wall \_\_\_\_\_ built as party wall \_\_\_\_\_ and \_\_\_\_\_ in a good and safe condition to be used as proposed. Building occupied as follows: basement \_\_\_\_\_, 1st floor \_\_\_\_\_, 2d floor \_\_\_\_\_, 3d floor \_\_\_\_\_, 4th floor \_\_\_\_\_, 5th floor \_\_\_\_\_, 6th floor \_\_\_\_\_, 7th floor \_\_\_\_\_, 8th floor \_\_\_\_\_, 9th floor \_\_\_\_\_, 10th floor \_\_\_\_\_.

What is the nature of the ground \_\_\_\_\_

What kind of sand was used in the mortar? \_\_\_\_\_

If building is VACANT, state how the same was occupied? \_\_\_\_\_

Is the PRESENT building to be connected with any ADJOINING building? \_\_\_\_\_ If so, state dimensions and material of adjoining building, viz.: Material \_\_\_\_\_; feet front \_\_\_\_\_; feet rear \_\_\_\_\_; feet deep \_\_\_\_\_; feet in height \_\_\_\_\_; number of stories \_\_\_\_\_; how occupied? \_\_\_\_\_

(The Inspector must here state what defects, if any, are in the walls.)

(The Inspector must state the thickness of wall \_\_\_\_\_ in each and every story.)

Inspector.

DEPARTMENT OF HOUSING AND BUILDINGS

OF THE

BOROUGH OF Manhattan, CITY OF NEW YORK

MANHATTAN  
Municipal Bldg.,  
Manhattan

BROOKLYN  
Municipal Bldg.,  
Brooklyn

BRONX  
Bronx County Bldg.,  
Grand Concourse & E. 161st St.,  
Bronx

QUEENS  
21-10 49th Avenue,  
L. I. City

RICHMOND  
Boro Hall,  
St. George, S. I.

NOTICE—This Application must be TYPEWRITTEN and filed in TRIPLICATE and ONE copy sworn to by Applicant.

**BUILDING NOTICE**

**Application for Minor Structures, Minor Alterations and Repairs**

PERMIT No. 19

APPLICATION No. 1938 WARD No.

LOCATION 319 East 10th St

ZONE

USE

HEIGHT

, City of New York Apr. 28 1938

AREA

To THE BOROUGH SUPERINTENDENT:

Application is hereby made for approval of the plans and specifications herewith submitted, and made a part hereof, for the erection or alteration of the building therein described,—with the understanding that if no work is performed hereunder within one year from the time of issuance, this approval shall expire by limitation as provided by law; and the applicant agrees to comply with all the rules and regulations of the Department of Housing and Buildings for the Borough of Manhattan, all provisions of the Building Code of the City of New York, and with every other provision of law relating to the erection or alteration of said building in effect at this date.

(Sign Here) 319 East 10th St. Corp. APPLICANT  
by Joseph H. Roberts Secy.

**SEPARATE PERMIT SHOWING PROOF OF WORKMEN'S COMPENSATION, MUST BE PROCURED BEFORE COMMENCING WORK**

(HERE STATE DEFINITELY NATURE OF PROPOSED WORK)

I propose to Install new iron stairs from 1st. to 2nd. floors in lieu of existing wooden stairs. New iron balusters with facias up stairs. no structural changes.

contractor and father doing work, not employing help.

5/2/38

Is this a new or old building? old

If old building, give character of construction brick

Number of stories high 4

How occupied tenement

Is application made to remove a violation? no same

How to be occupied

Cost \$ \$150.

PUBLIC SAFETY DESK

DEPARTMENT OF HOUSING  
AND BUILDINGS  
BOROUGH OF  
CITY OF NEW YORK

BUILDING  
NOTICE

Date \_\_\_\_\_  
House Number \_\_\_\_\_  
Signed \_\_\_\_\_  
Highway Bureau  
Width of Street \_\_\_\_\_  
Distance from Curb  
To Building Line \_\_\_\_\_  
Signed \_\_\_\_\_  
Topographical Bureau

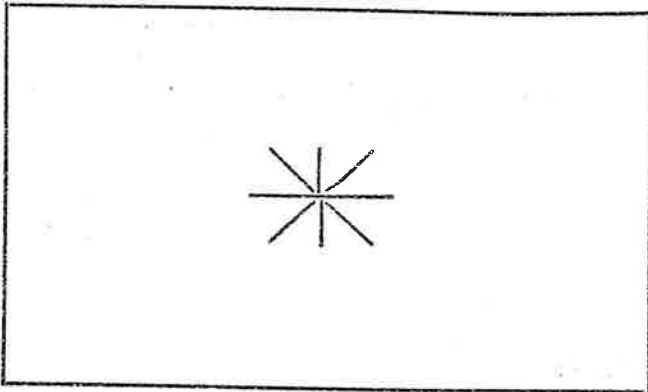

Section \_\_\_\_\_  
Vol. \_\_\_\_\_  
Block \_\_\_\_\_  
Lot \_\_\_\_\_  
Signed \_\_\_\_\_  
Deputy Tax Commissioner

STATE AND CITY OF NEW YORK, }  
COUNTY OF New York } ss.:

Jos. H. Kutner Secretary for 318 E. 10th St Corp being duly sworn  
deposes and says: That he resides at 363-7 Ave  
Borough of Manhattan City of New York; that he is the agent for the (owner-lessee)  
of the premises above described and is duly authorized to make this application; that the work to be done is duly  
authorized by the owner.

Deponent further says that the full names and residences of the owners or lessees of said premises are:

Owner 318 E. 10th St Corp Residence 318 E. 10th St

Lessee \_\_\_\_\_ Residence \_\_\_\_\_

Sworn to before me this 29th day of April, 1938  
Joseph H. Kutner Applicant

Charles Goldkey  
Commissioner of Deeds, City of New York  
Residing in the Borough of Manhattan  
N.Y. Co. Clerk's No. 15245068 exp. May 12, 1938

Work commenced May 20 Date signed off May 6 1938

**I hereby Certify** that the above report is true in every respect and that the work indicated has been  
done in the manner required by the Rules and Regulations of this Department, except where reported adversely.

Signed \_\_\_\_\_  
Inspector

EXAMINED AND RECOMMENDED

FOR APPROVAL ON \_\_\_\_\_ 19 38

APPROVED 5/6 1938  
Guarino Examiner

Borough Superintendent, Borough of Manhattan  
RECEIVED - DEPT. OF HOUSING AND BUILDINGS



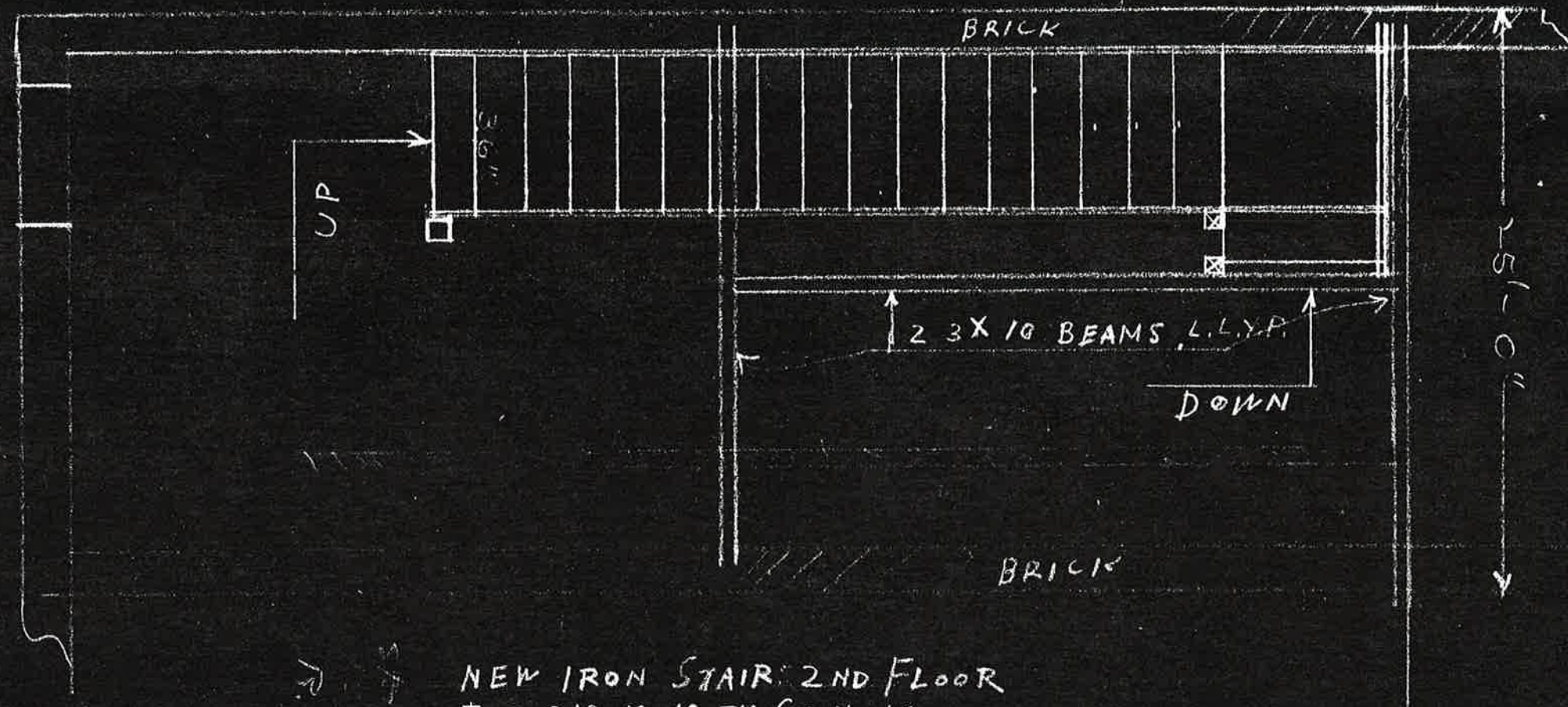

NEW IRON STAIR 2ND FLOOR  
 JOB 319 E 10 TH ST N.Y.C.

SCALE  $\frac{3}{8}$ " TO 1'-0"

13'-7 1/2"  
 STAIR STRING  
 7/8"