

Original

285

B 443  
L 23

# Department of Buildings,

OFFICE, No. 2 FOURTH AVENUE.

New York, March 7<sup>th</sup> 1871

## PLAN AND SPECIFICATION.

### INFORMATION REQUIRED IN RECORDING PLANS AND SPECIFICATIONS FOR THE ERECTION OF BUILDINGS.

1. Number of buildings to be erected, one
  2. Location, street number, or side of street, and number of feet from nearest corner, 73 Second St
  3. Size of lot, 25- feet front, 25- feet rear, 69 1/2 feet deep.
  4. Size of building, 25 1/2 feet front, 25 1/2 feet rear, 52 feet deep, 52 feet in height, from curb level to highest point. **Number of stories in height,** 5-
  5. Estimated value of the materials and labor required in the erection of each building, \$ 100000
  6. Depth of foundation from curb level or surface of ground (in no case to be less than four feet, except when laid upon solid rock), 10 ft
  7. Size of base stones, and how laid, 2.6 ft x 4 ft
  8. Thickness of foundation walls and piers, of what materials, and how laid; footing courses, timber or piles 24 in. Stone laid in Hydraulic lime mortar to sharp edges
  9. Thickness of upper walls, of what materials, and how laid, 12 in. Brick laid as above in good lime & sand mortar
- Extract from Law. "The mortar used in the construction of any building shall be composed of lime or cement mixed with sand, in proper proportions; no inferior lime or cement shall be used, and all sand shall be clean sharp grit, free from loam, and all the joints in all walls must be filled with mortar."
10. Materials of front. If stone, state the kind, give thickness of ashlar and backing, Philadelphia and Rochester on 1<sup>st</sup> story  
(All backing to be not less than 12 inches thick, and must be laid up with cement mortar.)
  11. Materials of roofing, tin
  12. Materials of cornices, galvanized iron
  13. Iron shutters, \_\_\_\_\_
  14. Style of roof. Flat, Peak, or Mansard, Peak
  15. Access to roof, Stair and Buck head How ventilated, usual way
  16. Independent walls, cast iron wall thickness of, 12" inches.
  17. Party-walls cast iron wall thickness of, 12" inches.
  18. Walls coped; what material, blue stone
  19. Sizes of floor beams; 1st tier, 3x10 inches; 2d tier, 3x10 inches; 3d tier, 3x7 inches; 4th tier, 3x7 inches; 5th tier, 3x8 inches; 6th tier, \_\_\_\_\_ inches; roof tier, 3x8 inches; material, spruce distance from centres, 16 in.
  20. Girders under floor beams, if any; size of same, of what materials, and how supported, iron  
iron under 1<sup>st</sup> tier supported in brick piers  
the wall partitions to be set as the building progresses

34. Give diagrams of floors in all cases.

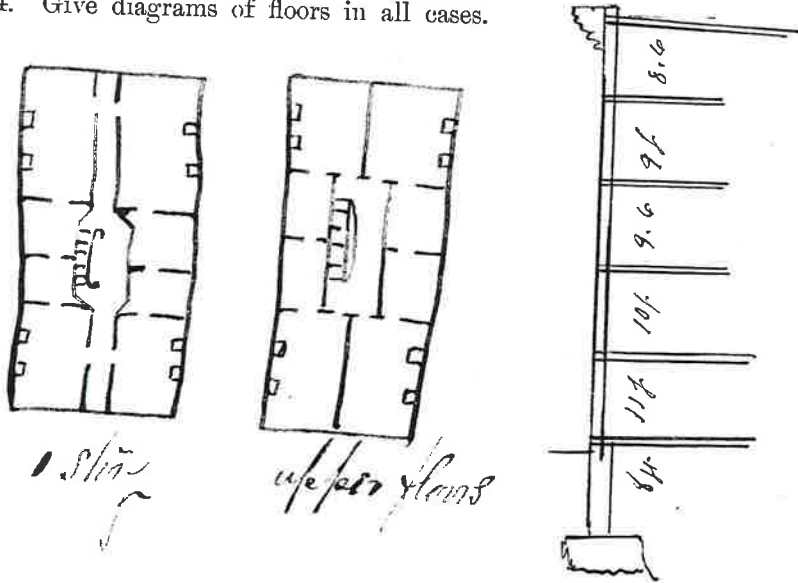

Owner C. G. Griesler Residence \_\_\_\_\_  
 Architect H. C. Manning Residence 20 Chrystie St  
 Builder C. Giesler Residence \_\_\_\_\_

**REPORT ON APPLICATION.**

New York March 11 1871

To the Superintendent of Buildings:

I respectfully report, that I have examined the wall named in the above application, and find the foundation wall to be built of stone inches thick; the upper wall built of brick, 12 inches thick, 8 feet deep, 12 feet in height, and in a good and safe condition to be used as proposed.

[Signature]  
 Deputy Superintendent of Buildings.

REMARKS.

**REPORT OF INSPECTOR.**

New York June 30<sup>th</sup> 1871

To the Superintendent of Buildings:

Work was commenced on the within described building on the 1 day of April 1871 and completed on the 24<sup>th</sup> day of June 1871 and has been done in accordance with the plan and specification except as noted below.

William DeKey  
 Inspector.

REMARKS.

Above plans all completed with