

B405
19

PLAN No. 1293

Original

1

DETAILED STATEMENT OF SPECIFICATIONS FOR ALTERATIONS, ADDITIONS, OR REPAIRS TO BUILDINGS ALREADY ERECTED.

- 1. State how many buildings to be altered One
- 2. What is the Street or Avenue and the number thereof 502 East 12th St.
- 3. Ward 7th

—:0:—

PRESENT BUILDING.

Give the following information as to the present building:

- 1. Size of lot on which it is located, No. feet front, 28; feet rear, 28; feet deep, 52
- 2. Size of building, No. of feet front, 28; feet rear, 28; feet deep, 45; No. of stories in height, 5, No of feet in height, from curb level to highest point, 46
- 3. Material of building, hard brick; Material of front, hard brick
- 4. Whether roof is Peak, Flat, or Mansard, flat
- 5. Material of Roofing, tin
- 6. Depth of foundation walls, 12 feet; thickness of foundation walls, 30; materials of foundation walls, Stone
- 7. Thickness of upper walls, 12 inches. Material of upper walls, hard brick
- 8. Whether Independent or Party-walls, all walls independent
- 9. Whether there is any other building on the lot, none
- 10. How the building is occupied, 10 families

—:0:—

HOW TO BE ALTERED.

IF RAISED OR BUILT UPON,

Give the following information:

- 1. How many stories will the building be when raised?
- 2. How many feet high will the building be when raised?
- 3. Will the roof be Flat, Peak, or Mansard?
- 4. What will be the material of Roofing?
- 5. What will be the material of Cornices and Gutter?
- 6. What will be the means of access to roof?
- 7. Will a Fire-escape be provided, if required?
- 8. Will Iron Shutters be provided, if required?
- 9. How will the building be occupied?

IF EXTENDED ON ANY SIDE,

Give the following information :

- 1. Size of extension, No. of feet front, ...; feet rear, ...; feet deep, ...; No. of stories in height, ...; No. of feet in height, ...
2. What will be the material of foundation walls of extension? ... What will be the depth? ...feet. What will be the thickness? ... inches.
3. What will be the material of upper walls of extension? ... How thick will the upper walls be? ... inches.
4. Will the roof of extension be Flat, Peak, or Mansard?
5. What will be the material of Roofing?
6. What will be the material of Cornice and Gutter?
7. Will Iron Shutters be provided, if required?
8. How will the extension be occupied?
9. How will the extension be connected with present or main building?

—:0:—

IF ALTERED INTERNALLY,

Give definite particulars, and state how the building will be occupied; and, if for a dwelling, state by how many families.

Handwritten lines for providing details on internal alterations.

—:0:—

IF THE FRONT, REAR, OR SIDE-WALLS, OR ANY PORTION THEREOF, ARE TO BE TAKEN OUT AND REBUILT,

Give definite particulars, and state in what manner.

Handwritten note: Take out one brick pier 2 ft wide in front of first story and place a 6" Cast iron round column with base. Set on a 12" granite block.

THE FOLLOWING INFORMATION IS ALSO REQUIRED.

- 1. If the building is to be occupied as a tenement building after the proposed alteration, will it be altered in every respect to conform to the provisions of Section 28 of the Building Law? No
2. How much will the alteration cost? \$ 400.00
3. Will all materials and workmanship be in accordance with the provisions of the law? Yes
Owner, Henry Terheinen Address, 92 Fulton St
Architect, Henry Beck Address, 57 Marion St
Mason, Address,
Carpenter, Address,

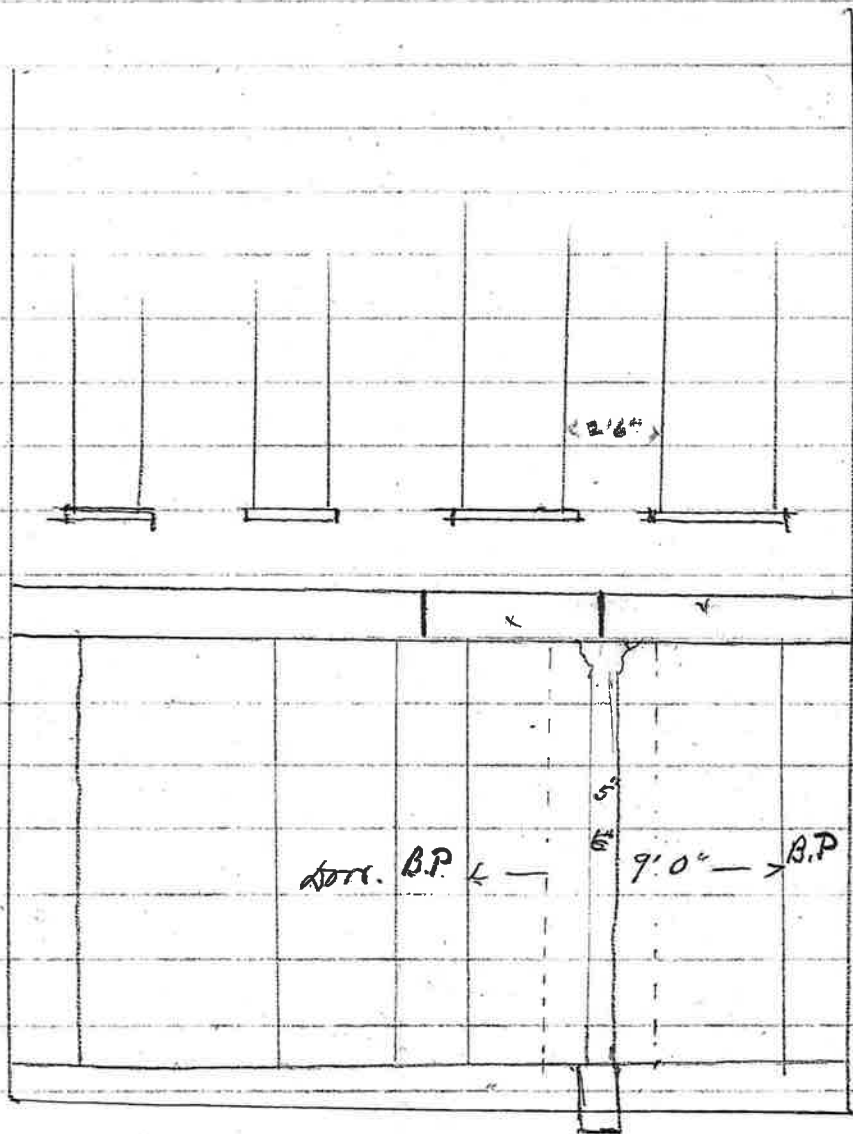

4'6"

118

1273 alt.
1881.



MEMORANDA.

Inspected
Feb 2nd 1882
Approved

the brown stone lintels to be
cut
between and replaced by
Cast iron lintels of sufficient
strength to rest in the masonry
on an 8" round column with
granite cap &c. with joists
bracing in each end.

Approved
M. P. Estabrook
Feb 2nd 1882 Inspector
Feb 2nd 1882
Inspector

M. P. Estabrook
Inspector of Buildings

Original
Fire Department, City of New York,

BUREAU OF INSPECTION OF BUILDINGS.

Detailed Statement of Specifications
FOR
ALTERATIONS TO BUILDINGS.

No. *1213* Submitted *Nov 3rd* 188*1*

LOCATION. *502 East 13th St.*

Owner *Henry Althaus*

Architect *Henry Beck*

Builder _____

Referred to *Exam Nov 3* 188*1*

Returned by _____ 188*1*

Report _____ favorable.

New York, *Nov 5* 188*1*

This is to certify that I have examined the within detailed statement, together with a copy of the plans relating thereto, and find the same _____ *not* to be in accordance with the provisions of the Laws relating to Buildings in the City of New York; that the same has been _____ *as* approved, and entered in the records of this Bureau.

By order of the Board of }
Fire Commissioners. }

M. P. Estabrook
Inspector of Buildings.

Referred to Examiner *5th Dist*

Feb 2 188*2*

Returned *May 7th* 188*2*

Rings
Examiner.

REPORT UPON APPLICATION.

Fire Department, City of New York,

BUREAU OF INSPECTION OF BUILDINGS,

New York, May 1st 1882

To the Inspector of Buildings:

I respectfully report, that I have examined the above named premises, and find said building to be built of brick 5 stor 5, 57 feet in height, 5 feet front, 8 feet deep, flat roof. The foundation walls are built of stone, 20 inches thick; the upper walls are built of brick 12 inches thick, and 57 feet in height from curb level.

brick independent wall, 1 party wall, and is in a good and safe condition ~~to be altered and enlarged~~ in the manner proposed, and in conformity with the provisions of the ~~Laws~~ relating to buildings in the City of New York.

John Riley
Examiner.

REMARKS.

The brick face of the wall to be taken up is 22" in the face, leaving a bearing of 11" each side of joint of brown stone. The stone is a good size and is properly supported. The front sink is very long and could accommodate a stone on top of it. It should be not less in length than the face of the wall. It is to be taken up and replaced with a new one.

John Riley
Examiner.



REPORT OF EXAMINER.

New York, May 1st 1882

To the Inspector of Buildings:

Work was commenced on the building described herein on the 8th day of March 1882 and completed on the 29th day of April 1882, and has been done in accordance with the plans and specifications, except as noted below.

Respectfully submitted,
John Riley
Examiner.

REMARKS.

.....
.....
.....
.....
.....

First 14th STREET

First 18th STREET

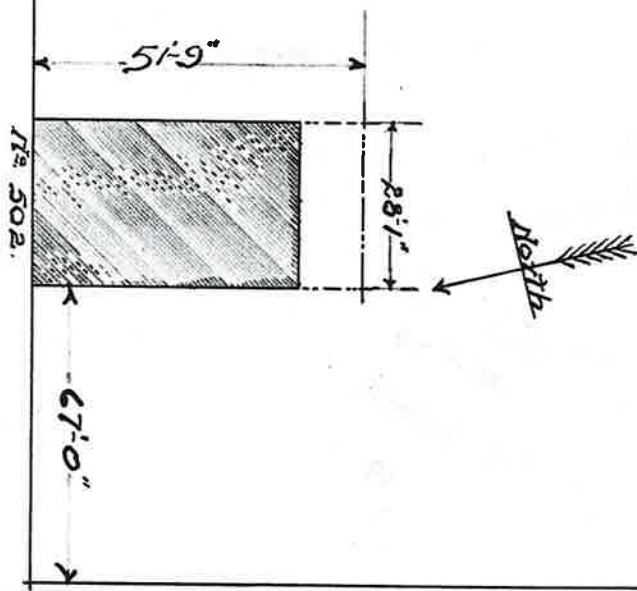

RYERUS A.

also

Office

of the President of the Borough of Manhattan,

In The City of New York.

DEPARTMENT OF BUILDINGS FOR THE BOROUGH OF MANHATTAN

Office, No. 220 FOURTH AVENUE,

S. W. Corner 48th Street.

PLAN No. 3140 (NEW BUILDINGS) ALTERATIONS 1907

Location 502 E. 12th St.

BOROUGH OF MANHATTAN.

In all cases Inspectors will furnish the following information without regard to the information given in the application and plans on file in the Bureau.

- 1. Foundation walls. Depth below curb level 9 inches; material Stone. thickness, front 20 inches; rear 20 inches; side 20 inches; party _____ inches.
- 2. Upper walls. Material Brick, thickness as follows:

Basement:	front _____ inches;	rear 12 inches;	side 12 inches;	party _____ inches.
1st story:	" col " "	12 " "	12 " "	" "
2d story:	" 12 " "	12 " "	12 " "	" "
3d story:	" 12 " "	12 " "	12 " "	" "
4th story:	" 12 " "	12 " "	12 " "	" "
5th story:	" _____ " "	" _____ " "	" _____ " "	" _____ "
6th story:	" _____ " "	" _____ " "	" _____ " "	" _____ "
- 3. Nature of ground _____
- 4. Quality of sand used in mortar _____
- 5. What walls are built as party walls? _____
- 6. What fire escapes are provided? _____
- 7. Is building fireproof? _____
- 8. If building is vacant, state how the same was occupied. Store & Tenement
- 9. Is the present building to be connected with any adjoining building? _____
If so, state dimensions and material of adjoining building, viz:—
Material _____; feet front _____, feet rear _____
feet deep _____; feet in height _____; number of stories _____
how occupied _____
- 10. How is present building occupied? Basement _____; 1st floor Store; 2d floor Ten; 3d floor Ten; 4th floor Ten; 5th floor _____; 6th " _____; 7th " _____; 8th " _____; 9th " _____
- 11. Height of building—feet 47; stories 4
- 12. Size of building—feet front _____; feet rear _____; feet deep _____
- 13. Size of lot— " " _____; " " _____; " " _____
- 14. Are fireproof shutters provided? _____ What kind? _____

Dated, Dec 24 1907

William J. M. Carter Inspector.

REPORT OF INSPECTOR AS TO COMMENCEMENT OF WORK.

The City of New York, Borough of Manhattan, _____ 190

To the Superintendent of Buildings for the Borough of Manhattan:

Work was commenced on the within described building on the 2 day of March 1908

Respectfully submitted,

Inspector.

FINAL REPORT OF INSPECTOR.

The City of New York, Borough of Manhattan, _____ 190

To the Superintendent of Buildings for the Borough of Manhattan:

Work was completed on the within described building on the 30th day of April 1908 and all the iron and steel girders, beams and columns are properly set, and of the size as per application, and all the work upon said building has been done in accordance with the foregoing detailed statement, except as noted below.

Respectfully submitted,

William McEntee Inspector.

REMARKS.

Multiple horizontal lines for handwritten remarks.

THE BUREAU OF BUILDINGS OF THE CITY OF NEW YORK
FOR THE BOROUGH OF MANHATTAN.

PLAN No. 111 of 190

State and City of New York, }
County of New York, } ss.:

Erwin Roszbach

being duly sworn, deposes and says: That he resides at Number 1947 Broadway
in the Borough of Manhattan
in The City of New York, in the County of New York
in the State of New York; that he is architect for the
Mr. Abraham Weiss, the

owner, in fee of all that certain lot, piece or parcel of land, shown on the diagram annexed hereto and made
a part hereof, situate, lying and being in the Borough of Manhattan

in The City of New York, aforesaid, and known and designated as Number 502 West 12th St.
and hereinafter more particularly described;

that the work proposed to be done upon the said premises, in accordance with the accompanying detailed
statement, in writing, of the specifications and plans of such proposed work, is duly authorized to be
performed by Mr. Abraham Weiss, the owner.

and that Erwin Roszbach
duly authorized by Mr. Abraham Weiss, the owner

to make application for the approval of such detailed statement of specifications and plans in his
behalf.

Deponent further says that the full names and residences, street and number, of the owner or owners
of the said land, and also of every person interested in said building or proposed building, structure, or
proposed structure, premises, wall, platform, staging or flooring, either as owner, lessee, or in any repre-
sentative capacity, are as follows:

Abraham Weiss No. 120 Bronx Street, New York
as owner

Erwin Roszbach No. 1947 Broadway, New York
as architect

No
as

No
as

No
as

The said land and premises above referred to are situate at, bounded and described as follows, viz. :

BEGINNING at a point on the ~~South side of~~ ^{East} side of ^{East} ~~12th Street~~ ^{12th Street}, distant ^{67'-0"} ~~67'-0"~~ feet
^{East} from the corner formed by the intersection of
^{East 12th St.} and ^{Avenue A}
running thence ^{East 25'-1"} feet;
thence ^{South 51'-9"} feet;
thence ^{West 28'-1"} feet;
thence ^{North 51'-9"} feet
to the point or place of beginning.

Sworn to before me, this 19 day of Dec 1900 }

Erwin Rombach

J. F. Rusk
Notary Public N.Y. County.

Applicant must indicate the Building Line or Lines clearly and distinctly on the Drawings.

B
19

Office of the Borough President of the Borough of Manhattan, In The City of New York.

THE BUREAU OF BUILDINGS FOR THE BOROUGH OF MANHATTAN,
Office, No. 220 FOURTH AVENUE,
S. W. Corner 18th Street.

Plan No. _____

APPLICATION TO ALTER, REPAIR, ETC.

Application is hereby made to the Superintendent of Buildings of The City of New York, for the Borough of Manhattan, for the approval of the detailed statement of the specifications and plans herewith submitted, for the alteration or repairs of the building herein described. All provisions of the Law shall be complied with in the alteration or repair of said building, whether specified herein or not.

(Sign here) Erwin Roubach

The City of New York, Borough of Manhattan, Dec 13 1907

LOCATION AND DESCRIPTION OF PRESENT BUILDING.

- State how many buildings to be altered one
- What is the exact location thereof? (State on what street or avenue, the side thereof, the number of feet from the nearest street or avenue, and the name thereof) 502 East 12th Str.
S.W. of 12th Str. 67'-0" East of Ave. A.
- How was the building occupied? Tenement + stores
How is the building to be occupied? "
- Is the building on front or rear of lot? front Is there any other building erected on lot or permit granted for one? no Size _____ x _____; height _____ How occupied? _____ Give distance between same and proposed building _____ feet.
- Size of lot? 28'-1" feet front; 28'-1" feet rear; 51'-9" feet deep.
- Size of building which it is proposed to alter or repair? 28'-1" feet front; 28'-1" feet rear; 7 feet deep. Number of stories in height? 5 Height from curb level to highest point? 49'-6"
- Depth of foundation walls below curb level? 7'-0" Material of foundation walls? Stone Thickness of foundation walls? front 20 inches; rear 20 inches; side 20 inches; party _____ inches.
- Material of upper walls? Brick If ashlar, give kind and thickness _____
- Thickness of upper walls:
Basement: front _____ inches; rear _____ inches; side _____ inches; party _____ inches.
1st story: " 12 " " 12 " " 12 " " " _____ "
2d story: " 12 " " 12 " " 12 " " " _____ "
3d story: " 12 " " 12 " " 12 " " " _____ "
4th story: " 12 " " 12 " " 12 " " " _____ "
5th story: " 12 " " 12 " " 12 " " " _____ "
6th story: " _____ " " _____ " " _____ " " " _____ "
- Is roof flat, peak or mansard? flat

11. Size of present extension, if any? _____ feet front ; _____ feet deep ; _____ feet high.
12. Thickness and material of foundation walls? _____
13. Material of upper walls? _____ If ashlar, give kind and thickness _____
14. Thickness of upper walls :
 Basement: front _____ inches ; rear _____ inches ; side _____ inches ; party _____ inches.
 1st story: " _____ " " _____ " " _____ " " _____ "
 2d story: " _____ " " _____ " " _____ " " _____ "
 3d story: " _____ " " _____ " " _____ " " _____ "
 4th story: " _____ " " _____ " " _____ " " _____ "
15. Is present building provided with a fire escape? Yes

If to be extended on any side, give the following information :

16. Is extension to be on side, front or rear? _____
17. Size of proposed extension, feet front _____ ; feet rear _____ ; feet deep _____ ; number of stories in height? _____ number of feet in height? _____
18. Material of foundation walls? _____ ; depth _____ feet ; material of base course _____ ; thickness of base course _____ ; thickness of foundation walls, front _____ inches ; side _____ inches ; rear _____ inches ; party _____ inches.
19. Will foundation be on rock, sand, earth or piles? _____
20. What will be the size of piers in cellar? _____ ; distance on centres? _____ ; size of base of piers? _____ : thickness of cap stones? _____ ; of bond stones? _____
21. Material of upper walls? _____ ; material of front? _____
22. Thickness, exclusive of ashlar, of upper walls :
 1st story: front _____ inches ; rear _____ inches ; side _____ inches ; party _____ inches.
 2d story: " _____ " " _____ " " _____ " " _____ "
 3d story: " _____ " " _____ " " _____ " " _____ "
 4th story: " _____ " " _____ " " _____ " " _____ "
 5th story: " _____ " " _____ " " _____ " " _____ "
 6th story: " _____ " " _____ " " _____ " " _____ "
23. With what will walls be coped? _____
24. Will roof be flat, peak, or mansard? _____ ; material _____
25. Give size and material of floor and roof beams _____

1st tier, material _____ ; size _____ ; distance on centres _____
 2d tier, " _____ " _____ " _____ "
 3d tier, " _____ " _____ " _____ "
 4th tier, " _____ " _____ " _____ "
 5th tier, " _____ " _____ " _____ "
 Roof tier, " _____ " _____ " _____ "

Give thickness of headers _____ of trimmers _____

26. Give material of girders _____ of columns _____
- Under 1st tier, size of girders _____ ; size of columns _____
 " 2d " " " _____ ; " " _____
 " 3d " " " _____ ; " " _____
 " 4th " " " _____ ; " " _____
 " 5th " " " _____ ; " " _____
 " Roof tier, " " _____ ; " " _____

If the Front, Rear or Side Walls, or any portion thereof, are to be taken out and rebuilt, give definite particulars, and state in what manner:

47. New windows broken through rear wall for W.L. accommodations also through side walls for Bedroom windows. Two giers taken out in front wall on 1st story, and upper wall to be supported by R. I. columns and girders. New pier in cellar front.

If altered internally, give definite particulars, and state how the building will be occupied:

48. New partitions for W.L. accommodations; close up each window from halls to bed rooms, close up opening for sink in upper stories, New skylight provided as per Rec. 83 I.H.A. New store fronts + vestibule, provide 1000 Gallon cypress roof tank, Rearrange power plumbing fixtures + provide new ones where shown.

49. How much will the alteration cost? \$ 7,500.00

If the Building is to be occupied as a Flat, Apartment or Lodging House, give the following particulars:

50. Is any part of building to be used as a store or for any other business purpose, if so, state for what?

Yes - store on 1st story

	Cellar	Basement	1st Floor	2d Floor	3d Floor	4th Floor	5th Floor	6th Floor
51. How many families will occupy each?	-	-	7	4	4	4	4	
52. Height of ceilings?	7'-0"		9'-0"	8'-6"	8'-0"	8'-0"	8'-0"	
					8'-3/4"	8'-0"	8'-1"	

53. How basement to be occupied? _____
How made water-tight? _____

54. Will cellar or basement ceiling be plastered? Yes How? Plaster board, lead lined

55. How will cellar stairs be enclosed? present

56. How will cellar be occupied? storage
How made water-tight? concrete

57. Will shafts be opened or covered with louvre skylights full size of shafts? _____

Size of each shaft? _____

58. Dimensions of water closet windows? not less than 1'-0" x 3'-0" B.S.B.
 Dimensions of windows for living rooms? present
59. Of what materials will hall partitions be constructed? "
60. Of what materials will hall floors be constructed? "
61. How will hall ceilings and soffits of stairs be plastered? "
62. Of what material will stairways be constructed? "
 Give sizes of stair well holes? "
63. If any other building on lot, give size; front 76; rear _____; deep _____;
 stories high _____; how occupied _____; on front or rear
 of lot _____; material _____.
 How much space between it and proposed building? _____.
64. How will floors and sides of water closets to the height of 16 inches be made waterproof? _____
slate floor + base set in cement
65. Number and location of water closets: Cellar _____; 1st floor 1; 2d floor 2;
 3d floor 2; 4th floor 2; 5th floor 2; 6th floor _____;
66. This building will safely sustain per superficial foot upon the 1st floor _____ lbs.; upon 2d floor
 _____ lbs.; upon 3d floor _____ lbs.; upon 4th floor _____ lbs.; upon 5th floor
 _____ lbs.; upon 6th floor _____ lbs.; upon 7th floor _____ lbs.; upon 8th floor
 _____ lbs.

Owner, Alv. Al. and W. Kies Address, 130 Broadway

Architect, Ernie Roseback " 1947 Broadway

Superintendent, _____ " _____

Mason, _____ " _____

Carpenter, _____ " _____



DEPARTMENT OF BUILDINGS

BOROUGH OF Manhattan, CITY OF NEW YORK

MANHATTAN
Municipal Bldg.,
Manhattan

BROOKLYN
Municipal Bldg.,
Brooklyn

BRONX
Bronx County Bldg.,
Grand Concourse & E. 161st St.,
Bronx

QUEENS
21-10 49th Avenue,
L. I. City

RICHMOND
Boro Hall,
St. George, S. I.

NOTICE—This Application must be TYPEWRITTEN and filed in TRIPLICATE

Location 508 East 12th Street Alt. No. 600-1150-175/36
 Block 405 Lot 9 Ward _____ Vol. _____ Bldg. _____
 Notice No. _____
 N. B. No. _____

Application for the Erection of Chapel

New York, Aug. 16 1937 1937

Application is herewith made by Capone Electrical Co, Inc.
(Name of Permittee)

1150 60 River Ave. Bronx,
Address

on behalf of Congregation of N. St. Del Socorro
(Name and address of owner of property)

for permission to Erect a wooden frame Chapel for Saint at 508 East 12th St.

Description of work wooden frame for chapel for 6 days Aug. 20, 21, 22, 1937
not over five feet beyond the building line

Work to be completed Aug. 20, 1937

File two plans on cloth, size 8" x 13", showing dimensions and work applied for.

Capone Electrical Co, Inc.
Rafely De Mauna
Applicant SEC. TRAS.

EXAMINED AND RECOMMENDED
FOR APPROVAL ON _____ 1937 Examiner _____

APPROVED AUG 19 1937 1937 Samuel Fisher
Commissioner of Buildings, Borough of _____

Work commenced Aug 20⁴ 1937 Date signed off Aug 26¹⁵ 1937

I Hereby Certify that the above report is true in every respect and that the work indicated has been done in the manner required by the Rules and Regulations of this Department, except where reported adversely.

Signed John J. Arcup
Inspector